

TUE 11 FEB 2025



Year 11 & 12 Information Evening

ST. GEORGE'S ANGLICAN GRAMMAR SCHOOL





Evening Schedule and Map

Evening Sessions

Time	Session	Location
6.00 – 6.30pm	Year 11 Information	Level 4
6.30 – 7.00pm	Year 12 Information	Level 4
	Year 11 Teacher Meet & Greet	Level 3
7.00 – 7.30pm	Year 12 Teacher Meet & Greet	Level 3

Meet and Greet Map

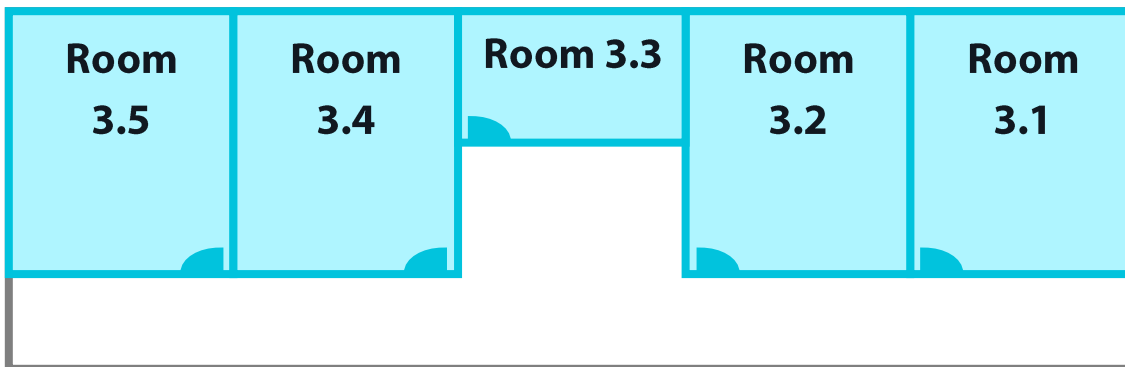

Room 3.1

- ATAR/APEX Human Biology
- Flexitrack High
- ATAR Chemistry
- ATAR Biology
- ATAR Physics
- ATAR Psychology
- ATAR/APEX Marine Studies

Room 3.2

- ATAR/APEX Visual Art
- APEX Dance
- ATAR/APEX English
- ATAR Literature
- ATAR/APEX Drama

Room 3.3

- APEX Design
- ATAR Computer Science
- Cert 3 Music Industry
- ATAR/APEX AIT
- APEX Chinese
- APEX Japanese

Room 3.4

- ATAR Maths Applications
- APEX Maths Essentials
- ATAR/APEX Maths Methods
- ATAR Maths Specialist

Room 3.5

- APEX Outdoor Ed
- ATAR Geography
- ATAR Politics and Law
- ATAR PE Studies
- APEX PE Studies
- ATAR Accounting and Finance
- ATAR/APEX Modern History
- ATAR Economics

Requirements of the WACE



- 1 Literacy and Numeracy Standard** Prequalify via Year 9 NAPLAN (Achieve Band 8 or higher in Reading, Writing and Numeracy) or Pass OLNA (Reading, Writing and Numeracy)
- 2 Breadth and Depth** Complete 20 Units in Year 11 & 12 (Minimum of 10 in Year 12, English is compulsory to study in Years 11 & 12, must have a List A and a List B course)
- 3 Achievement Standard** Of the 20 completed units (as a minimum), students must achieve a C Grade in at least 14 units across Years 11 & 12 (with at least 6 C Grades in Year 12)
- 4 Unit Equivalents** Students may substitute an ATAR or an APEx course with an Endorsed Programme or VET Qualification in Years 11 & 12

Student Academic Priorities

- Priority #1** Achieve WACE at the end of Year 12 by meeting all four requirements
- Priority #2** Maximise opportunities post-school (by striving for success in an ATAR or an APEx pathway)



ATAR Entry Estimates

University	Course	Minimum estimated ATAR	Lowest ATAR Offered
Curtin	Bachelor of Computing (Cyber Security)	80.00	90.30
	Bachelor of Education (Secondary Education) - Science Education in Chemistry	70.00	97.05
	Bachelor of Engineering (Honours) (Electrical and Electronic Engineering); Bachelor of Science (Science) in Computer Science (double degree)	80.00	90.80
	Bachelor of Science (Science) in Environmental Biology; Bachelor of Commerce (double degree)	70.00	91.35
	Bachelor of Applied Geology; Bachelor of Science in Environmental Biology (double degree)	70.00	96.40
	Bachelor of Science (Oral Health Therapy)	83.00	95.10
	Bachelor of Science (Science) in Physics; Bachelor of Commerce (double degree)	70.00	82.70
	Bachelor of Education (Secondary Education) - Mathematics Education	70.00	85.35
	Bachelor of Education (Primary Education)	70.00	92.30
ECU	Bachelor of Engineering Honours / Bachelor of Commerce (double degree)	80.00	96.00
	Bachelor of Engineering (Electrical and Renewable Energy) Honours	80.00	90.00
	Bachelor of Engineering (Computer Systems) Honours	80.00	96.20
	Bachelor of Engineering (Maritime) Honours	80.00	92.25
	Bachelor of Engineering (Mechatronics) Honours	80.00	94.60
	Bachelor of Education (Secondary) - Drama Education	70.00	88.30
Notre Dame	Bachelor of Arts (Architecture)	70.00	96.85
	Bachelor of Biomedical Science / Bachelor of Commerce (double degree)	70.00	98.80
	Bachelor of Commerce / Bachelor of Sport and Recreation Management (double degree)	70.00	83.15
	Bachelor of Health and Physical Education (Secondary)	70.00	95.55
	Bachelor of Human Resource Management	80.00	97.60



11/12 Pathways

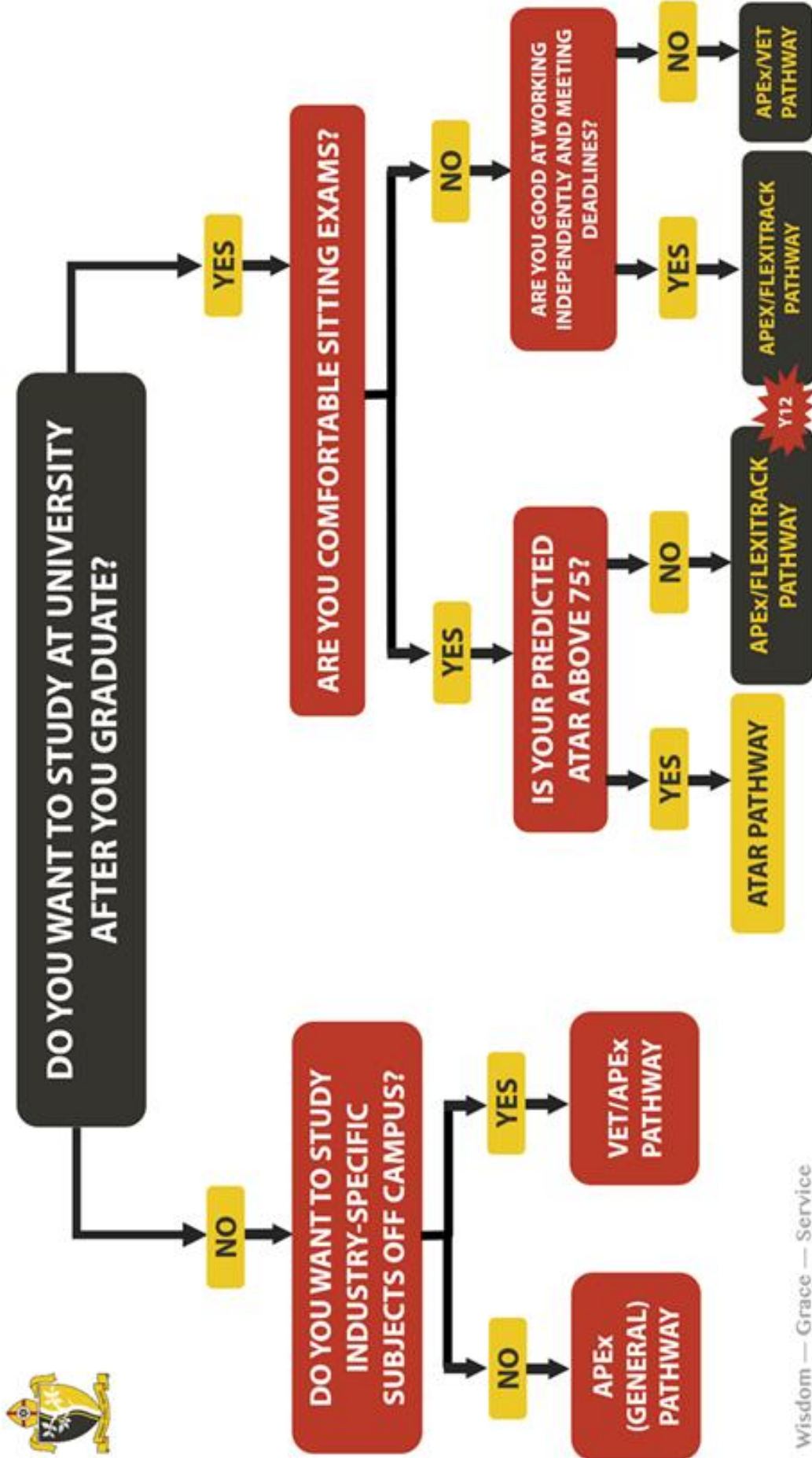



Missed Assessment Guide



Assessment Guide Years 10 - 12

Types of absence

- **Unplanned** - due to illness, injury or misadventure
- **Unapproved** - family holidays, driving test
- **Approved** - school event, sports event



What to do if you're absent

- Email your teacher as soon as you know you will be unable to submit/sit your assessment
- Arrange to submit work early
- Speak to your teacher about alternative arrangements
- Get a medical certificate from your GP if you are unwell



Missed Assessments

You can sit missed assessments at one of the following times. You must sit the assessment as soon as possible*.

- Tuesday, 3.45 pm
- Wednesday, 7.30 am
- Thursday, 3.45 pm



*Please refer to the assessment policy document for full details.

Late submissions

Late submissions of work will incur a 10% penalty for each day that your work is late, for a maximum of three days.

Work submitted later than day three after the due date will be awarded a zero.



Avoiding assessments

If you are concerned about an assessment, talk to your teacher about how they can support you.

Avoiding assessments can result in a zero grade.





Exam Timetables

Year 12 ATAR Exam Timetable Semester One 2025



Week	Session	Monday May 26	Tuesday May 27	Wednesday May 28	Thursday May 29	Friday May 30
Week 5	Morning Exam • Arrive at <u>8:00am</u> • Exam Starts at <u>8:30am</u>	Year 12 Normal School Day	Year 12 Normal School Day	No Year 12 Exams Scheduled	ATAR Literature (10) ATAR English (31)	Year 11 Exams Scheduled
	Afternoon Exam • Arrive at <u>12:30pm</u> • Exam Starts at <u>1:00pm</u>	Year 12 Normal School Day	Year 12 Normal School Day	No Year 12 Exams Scheduled	Year 11 Exams Scheduled	ATAR Mathematics Methods (22) ATAR Mathematics Applications (27)
Week	Session	Monday June 2	Tuesday June 3	Wednesday June 4	Thursday June 5	Friday June 6
Week 6	Morning Exam • Arrive at <u>8:00am</u> • Exam Starts at <u>8:30am</u>	WA Day Public Holiday	ATAR Physics (15) ATAR Biology (11) ATAR Psychology (11) ATAR 11 CSL (3)	Year 11 Exams Scheduled	ATAR PE Studies (11) ATAR Politics & Law (4) ATAR AIT (5) ATAR Chemistry (17) ATAR Visual Art (1)	Year 11 Exams Scheduled
	Afternoon Exam • Arrive at <u>12:30pm</u> • Exam Starts at <u>1:00pm</u>	WA Day Public Holiday	Year 11 Exams Scheduled	ATAR Human Biology (17) ATAR Geography (7) ATAR Com Sci (6)	Year 11 Exams Scheduled	ATAR Modern History (4) ATAR Mathematics Specialist (10) ATAR Drama (1) ATAR Accounting (9)

Year 11 ATAR Exam Timetable Semester One 2025



Week	Session	Monday May 26	Tuesday May 27	Wednesday May 28	Thursday May 29	Friday May 30
Week 5	Morning Exam • Arrive at <u>8:00am</u> • Exam Starts at <u>8:30am</u>	Year 11 Normal School Day	Year 11 Normal School Day	No Year 12 Exams Scheduled	Year 12 Exams Scheduled	ATAR Mathematics Methods (37) ATAR Mathematics Applications (32)
	Afternoon Exam • Arrive at <u>12:30pm</u> • Exam Starts at <u>1:00pm</u>	Year 11 Normal School Day	Year 11 Normal School Day	No Year 12 Exams Scheduled	ATAR Literature (20) ATAR English (43)	Year 12 Exams Scheduled
Week	Session	Monday June 2	Tuesday June 3	Wednesday June 4	Thursday June 5	Friday June 6
Week 6	Morning Exam • Arrive at <u>8:00am</u> • Exam Starts at <u>8:30am</u>	WA Day Public Holiday	Year 12 Exams Scheduled ATAR 11 CSL (3)	ATAR Accounting (4) ATAR Chemistry (28) ATAR Comp Sci (10) ATAR Dance (8) ATAR PAL (12)	Year 12 Exams Scheduled	ATAR AIT (16) ATAR Economics (12) ATAR Mathematics Specialist (11) ATAR Psychology (14) ATAR Visual Art (6)
	Afternoon Exam • Arrive at <u>12:30pm</u> • Exam Starts at <u>1:00pm</u>	WA Day Public Holiday	ATAR BME (11) ATAR Modern History (5) ATAR Marine and Maritime Studies (11) ATAR Human Biology (25)	Year 12 Exams Scheduled	ATAR Biology (15) ATAR Design (10) ATAR PE Studies (10) ATAR Drama (10) ATAR Physics (21)	Year 12 Exams Scheduled



Exam Timetables

Year 12 Externally Set Task Timetable Semester One 2025

EST Location: Regularly scheduled classroom



Week	Monday 12 May	Tuesday 13 May	Wednesday 14 May	Thursday 15 May	Friday 16 May
Term 2 Week 3	Period 1/2: APEX Human Biology APEX Design	Period 1/2: APEX Applied Info Tech APEX Dance APEX PE Studies APEX Visual Art	No ESTs	Period 1/2: APEX English	Period 4: APEX Chinese as a s Second Language
Week	Monday 19 May	Tuesday 20 May	Wednesday 21 May	Thursday 22 May	Friday 23 May
Term 2 Week 4	Period 4: APEX Mathematics Essentials	Period 4: APEX Drama	Period 3/4: APEX Outdoor Education	Period 1/2: APEX Marine and Maritime Studies	Period 1: EST Catch-Up

