



*A great state school serving
the Lyndhurst community.*

OPENING 2011



September 2010

Issue 2:
The story continues



Principal's message Greg Lacey



Frequently asked questions

Answers to questions that
parents have been asking.

More about play based
learning.

More about our facilities.

Information night details.

A bit of Lyndhurst history.

Hello again and welcome to all of those families who have completed enrolment forms for Lyndhurst Primary School. Enrolments are coming in each day and it has been great to hear the enthusiasm of children and families for the new school. I've had many stories of families driving by the school checking on its progress and excited children interested in "their school" being ready for them. I've had many site visits to check on progress myself and I share that same enthusiasm. Certainly, the weather has not been kind to the builders but they are forging on regardless to make sure that we all have a fabulous new school to move into next year. I have to say that the Project Manager from Abbi Group, Nathan Delaney has been absolutely fabulous and he is as keen to see this school open on time and looking great as anybody. He has been so cooperative and is constantly communicating with me to ensure the school is exactly as we want it. Abbi have learnt many lessons after constructing several schools last year in the first round of the public-private partnership project. We stand to benefit greatly from these lessons.



Landscaping at the school site is well advanced, despite the inclement weather. Many advanced trees have been planted, the oval is well grassed and here we can see that some of the playground equipment is already in place.

FAQ's: What do you want to know about Lyndhurst Primary School?

If you have a question why not drop us an e-mail at: lyndhurst.ps@edumail.vic.gov.au

What's happening with uniform?

PSW has been selected as the supplier of Lyndhurst Primary School uniform. PSW has a local retail store (Hampton Park), a long history of quality service to schools and competitive pricing. They are currently organizing samples in the school's color scheme to present to parents at our information evening. Parents will, I'm sure, be pleased with the result. The final decision was made on the basis of an optimal combination of cost and quality. Uniform is a key component in building a strong and positive school culture. I want children to be proud to wear the Lyndhurst uniform. The school colors are teal-green with black and white. The drawings and samples from other schools with similar uniform colors look fantastic. The colors are distinctive and very smart looking. The teal-green has been developed specifically for Lyndhurst.

What's happening with books and stationery supplies?

Many stationery and book suppliers have been in contact with me but no decision has been made yet. That will be a decision for next term.

How are enrolments progressing?

Enrolments are coming in at a rate of a couple per day. It will be important from a planning perspective to have our numbers as accurate as possible as early as possible. If you know of anyone who will be bringing their children to Lyndhurst and they haven't enrolled yet, please give them a nudge and get them to contact me.

Is there more information about family meetings?

Parent information meetings will be held on October 12th at 6pm at Cranbourne Carlisle PS. Further information is on the back page of this newsletter.

FAQ continued



Lyndhurst PS How do I enroll?

The following are all required to complete enrolment:

- Completed Student Information Forms
- Copy of Birth Certificate
- Immunisation Certificate

Enrolment forms and documentation can be handed in to our host school at:

Cranbourne Carlisle
Primary School
15 Silky Oak Drive
Cranbourne, 3977

Or posted to:

Lyndhurst Primary School
PO Box 7138
Cranbourne North, 3977

Did you know there used to be an old Lyndhurst PS?

At the top of the hill on Westernport Highway, near the Glasscocks Road roundabout, is a house with a tree nursery attached. You may have seen it and you may have wondered about the unusual shape of the front building. You may even have thought that it looks like an old school building. Well, in fact it is an old school building. It is the old Lyndhurst Primary School! I'm still trying to track down some history of the Lyndhurst Primary School, or Lyndhurst State School as would have been known in the early days. I happen to know that, at one stage in its life, it used to be a rural annexe of Hampton Park East Primary School (now Rivergum Primary School). I know this because I used to teach there. From 1988-1990, I was an Info Tech teacher at Hampton Park East PS and I would regularly travel out to Lyndhurst to teach the 2 grades out there. The 2 grades were rural in style and structure with Preps to 2's in one room and 3's to 6's in another. The original Lyndhurst State School had a 3-digit school number, making it the one of the oldest schools in Victoria. I'll certainly pass on more information as I track it down and if any parents or community members have something that they can contribute, I'd love to hear from you. It's great for a school to have some history upon which to draw in establishing its identity.

What about Lyndhurst's School Council?

As I mentioned in the last newsletter, an Interim School Council will be established during 2010 and this will remain in place until elections are held for the 2012 School Council. Parent and community volunteers are being sought to serve on the council. If you are interested in joining the interim School Council of Lyndhurst PS, please send me an e-mail listing your name, contact details, names of students attending Lyndhurst PS, your occupation and any relevant information regarding the potential contribution you could make to the effective running of the council, eg former School Councilor at school, financial experience, committee memberships. I have one or two interested parents but I need a couple more please.

FAQ continued

How many students will be in each year level?

The number of students at each year level is a bit of a guess really. At this stage, the current enrolment rate indicates that we will start with 120-150 students. It is the nature of a new school in a new neighbourhood to experience significant growth during the year so we may finish next year with more like 200 or more students. It is also the nature of new schools to have significantly more students in the lower year levels rather than upper grades. I will endeavour to keep parents informed as the enrolment pattern reveals itself.

How many students will the school hold?

The main school building is built for about 425 students. Following that, allowance has been made on the grounds for relocatable buildings to be constructed should the population go beyond that. This is normal practice in state schools. It is expected that Lyndhurst will build towards 600 or so students before leveling out. The extra school facilities will certainly cater well for that many students and, as the school grows, it will be the job of the School Council to consider other building projects to ensure a full education for all.

Will ICT (computers) be a focus at Lyndhurst Primary School?

The school comes equipped with all of the necessary networking infrastructure to facilitate the amazing things that teachers and students do with computers in education. I have a strong background in ICT, having spent over 10 years teaching computer education in schools from as far back as the mid 1980's when a single computer in a school was a novelty. We will have a mix of Apple and Windows based computers, matched carefully to the needs of teachers and students and we will be ensuring that every classroom from Prep to year 6 is fitted out with the latest of quality educational ICT equipment like printers, interactive whiteboards, visualisers, electronic microscopes, projectors and scientific equipment.

What sports facilities will the school boast and what emphasis will there be on sport?

The school will be well supplied with fantastic sports facilities. If you have driven by, you may have seen that the school oval is already well-grassed and looking great. As a PPP school, we will be fortunate to start with a full sized gym, two outdoor basketball courts, plenty of grounds space for play, playground equipment and plenty of phys ed equipment! Sport to me, is a vital part of a school curriculum. Not only are there obvious health benefits from having happy, healthy and active students, there are myriad social and personal development benefits from a well-run program of physical activity and sport. I have played sport all of my life. I still play baseball, even at my age! There are no doubts that sport will be a high priority for Lyndhurst, not only for its own sake but also for its undeniable benefits in supporting students in their learning and wellbeing.

What about extra-curricular activities?

It's very hard to say exactly what sort of extra-curricular activities we will have at Lyndhurst. To some degree, this is reliant upon the passion and commitment and particular interests of the teaching team we assemble. I can confidently say that students will receive a broad and comprehensive education that has a focus on essential academics but will just as strongly focus on life skills, wellbeing and personal development through a wide variety of extra-curricular programs such as outdoor education, water safety, instrumental music and arts pursuits. Lyndhurst will provide every student with the opportunity to expand their horizons, pursue their passions and stretch their limits! If you want to see the kind of programs we ran at my previous schools, Tyabb Primary School, go to www.tyabbps.vic.edu.au and check it out.

Can we have a little more detail about the facilities at Lyndhurst?



Lyndhurst Primary School will come as a fully equipped school with an immense variety of flexible, purpose-built learning environments and facilities like: 17 classrooms, open library area, 6 shared learning neighbourhoods, 2 art/science areas, fully fitted out gym, well resourced music room, comprehensive wireless and wired computer network infrastructure, playground equipment, oval, painted paving activities, shade shelters, canteen, dedicated IT spaces, indoor student toilets, outdoor basketball courts, landscaped courtyards, spacious offices, meetings rooms and staff work rooms, a range of modern, comfortable, ergonomically-designed furniture and an outdoor learning space with native garden, seating and dry river bed. The school lies in close proximity to many kilometers of sculpted wetlands and shared bike/walking paths with neighbouring land allocated to a variety of community facilities and sporting infrastructure.

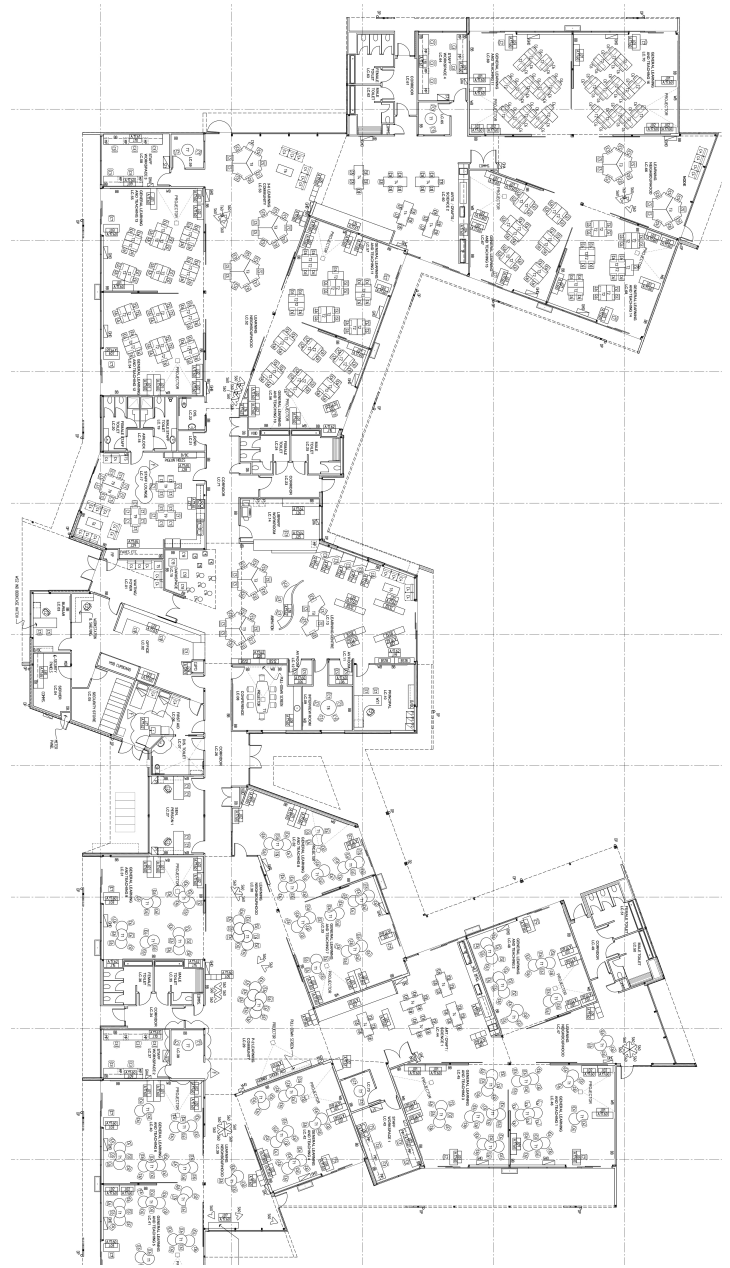

The schools built under this Public/Private Partnership model are state of the art in educational facilities allowing quality teachers to implement a learning program fully suited to 21st Century learners. Whilst it will take some time to fully resource the school, in terms of facilities, furniture and equipment, we will begin 2011 with a level of fit out that will be envy of other schools.

Some more about Lyndhurst Primary School?

In the last newsletter, I mentioned that we would be establishing a “play-based” curriculum in the Early Years (Prep-2) at Lyndhurst. Many of you may have wondered what this means. The curriculum we will be implementing will be based on the work of Kathy Walker. You can read more about Kathy and her work at.... earlylife.com.au. Below, is an article from Kathy, with some of her thoughts on children and play.

I have just finished reading a new book by a wonderful author and child expert, from the USA called David Elkind. He wrote a very well known book called *The Hurried child*, which actually inspired me to write my book, *What's the Hurry?*.

His new book is called *The Power of Play*. It emphasises how important play is in the life of a child, whether they are infants, toddlers, preschoolers or primary aged children. He talks a lot in the book about how there is less time for play, less value in play and so many toys and games available that even the nature of play itself is less engaging and rich.

Elkind's book is one I would recommend for all families and teachers. We need to be reminded and challenged to ensure our children are being given opportunities to play, to create, to imagine, to construct, to wonder and to enjoy.

Through play, children are able to experience roles they may not have had the chance to experience before. Play enables children to make sense of the things they are exposed to; to explore, to experiment, to imagine and to practise skills. Play also encourages language and conversation which is an important foundation for literacy. We need to try to value play in our own minds. Play requires time. Time to go down to the local park, to hang out in the backyard if there is one, or to engage in a range of experiences at home that provide opportunities for creative interactions and constructions. Children have wonderful imaginations and so we can provide some props for play to help make it rich and creative:

- Cardboard boxes that may become cars, or trams or houses
- Blankets that might become tents or caves or picnics
- Scrap material that might become dress ups
- Bits of wood that might be glued or hammered together
- Playdough
- Buckets of water to wash toys in
- Paper and cardboard and bits and pieces to paste with
- Little blocks
- Magnifying glass
- Bug catchers
- Scrap books to draw in rather than colouring in books

As a community, we often become caught up in the hype and clever marketing that toys have to be electronic, have to be computerised and that the more expensive they are, the better they will be. Children's toys and games should be of the kind that encourage children to use some of their own imagination, so that they can create the play around the toys and objects we provide for them.

Parents often feel guilty for not being able to afford expensive games and toys and yet, some of the richest and most meaningful play can be with junk materials.

Some children, as David Elkind states, have so many toys that they are often overwhelmed with so many to choose from and flit from one toy to another without every truly engaging in the play and using the toy in a rich and engaging way. They never get to value and use their toys well simply because they can just throw one aside and move to the next and the next.

We need to ensure that our children have time to play. Less TV and computer time, less electronic games and less DVDs. Getting children outside, thinking creatively, engaging in physical activity, learning how to self initiate their own play and to occupy themselves, are all important life skills. Life is not about endless entertainment and being scheduled into activities.

Being able to enjoy one's own company, play actively and interact with others and to feel the freedom of uninterrupted time to play and create and imagine is something all children need a lot more of.

Given the holidays are upon us, it is important to ensure as parents that you don't feel pressured into spending lots of money and having to go out each day. Balance your child's time so that sometimes they simply have to play.

Kathy Walker

Lyndhurst PS

By reaching out to make neighbourhood connections with homes, businesses, the environment and local institutions, Lyndhurst Primary School can:

- offer real world, rigorous, interdisciplinary learning experiences
- provide facilities custom-designed for learners of the 21st Century
- be a school characterised by the laughter and smiles of children
- wholly engage children and the community in the process of learning
- prepare children to be happy, caring and productive adults
- develop adaptable and resilient individuals
- encourage respect for themselves, others and the environment

In the next edition...

- More about the curriculum
- When can I get uniform?
- Do we have any staff yet?
- Parking facilities
- What is inquiry-based learning?
- Will we have school camps?
- What will the school's policies be on discipline, wellbeing, engagement, bullying and so on.
- What about children who are not keeping up?
- What about those who need extending?
- What about class sizes?
- Your questions e-mail them to us.

Lyndhurst Primary School newsletter



Issue 2: September 2010

Contact us:

70 Brookwater Parade
Lyndhurst, 3975

Principal: Greg Lacey
Phone: 0416 679 836

PO Box 7138
Cranbourne North, 3977

lyndhurst.ps@edumail.vic.gov.au



Lyndhurst Primary School Parent information night

Lyndhurst Primary School is a new school being built in the Marriott Waters Estate near the corner of Thompsons Rd and the Westernport Highway. It opens in 2011. This is your opportunity to find out about the exciting opportunities that exist for your children at... Lyndhurst Primary School.

Tuesday October 12th

6pm - 7.30pm

Location:

Cranbourne Carlisle PS

15 Silky Oak Drive

Cranbourne North, 3977

At this parent information night, we will be offering a short presentation on Lyndhurst Primary School but much of the night will be dedicated to answering your questions.

- The night will be conducted at Cranbourne Carlisle Primary School.
- We will take the opportunity to have a wander through the school.
- Cranbourne Carlisle is almost the same design as Lyndhurst Primary School and so parents can see first-hand, the facilities in which their children will be learning.

The evening is open to:

- all those who have already enrolled,
- all those who have expressed interest
- and anyone else who might be considering Lyndhurst Primary School.



So that we can plan accordingly,

Please RSVP your attendance to:

lyndhurst.ps@edumail.vic.gov.au

Call on: 0416 679 836

Or leave a message at Cranbourne Carlisle PS on 5991 3600