

24 October 2022

Dear Resident,

## Robinsons Road – Night works and road closures in November

The new Robinsons Road underpass is open to vehicles, months ahead of schedule, improving safety and creating better local connections.

We're **working during the night at times in November** to finish the new road underpass and minimise impacts to local traffic. **Works will be low impact** and include:

- Installing permanent traffic signals at the intersection of Robinsons Road and Quinn Street.
- Completing the dedicated right turn lane into Quinn Street.
- Finishing the new shared use path along Robinsons Road and closing the existing footpath across the level crossing.
- Asphaltting and line marking along Robinsons Road.

### How this will impact you

During this time, **Robinsons Road and nearby streets will be closed at times** with traffic management in place. Access to local businesses and residential properties will be maintained at all times.

We'll contact directly impacted properties ahead of works with more information about relocation.

#### Night works and travel changes from 7pm to 5am

##### Monday 7 November and Tuesday 8 November

- **Robinsons Road closed** in both directions between Waigani Avenue and Hatchlands Drive.
- **Nexus Street closed** at Robinsons Road.
- **Intersection of Robinsons Road and Quinn Street closed.**

##### Monday 14 November to Sunday 20 November

- **Lane closures at times** along Robinsons Road with traffic management in place.

##### Monday 21 November

- **Robinsons Road closed** in both directions between Waigani Avenue and Hatchlands Drive.
- **Nexus Street closed** at Robinsons Road.
- **Intersection of Robinsons Road and Quinn Street closed.**

##### Monday 28 November to Thursday 8 December

- **Robinsons Road closed** in both directions between Waigani Avenue and Hatchlands Drive.
- **Nexus Street closed** at Robinsons Road.
- **Intersection of Robinsons Road and Quinn Street closed.**
- **Commercial access road closed** at times.

#### CONTACT US

levelcrossings.vic.gov.au  
contact@levelcrossings.vic.gov.au  
1800 105 105

Level Crossing Removal Project,  
GPO Box 4509, Melbourne VIC 3001

     @levelcrossings



Translation service – For languages other than English, please call 9280 0780

Please contact us if you would like this information in an accessible format.

If you need assistance because of a hearing or speech impairment, please visit [relayservice.gov.au](https://relayservice.gov.au)



Authorised and published by the Victorian Government, 1 Treasury Place, Melbourne

- Residential access road closed at times.

Weather conditions may affect our progress and some dates may change.

### More information

If you have any further questions or queries throughout these works, please do not hesitate to contact the LXP 24/7 Contact Centre on **1800 105 105** or **contact@levelcrossings.vic.gov.au**.

### Robinsons Road closure detour map

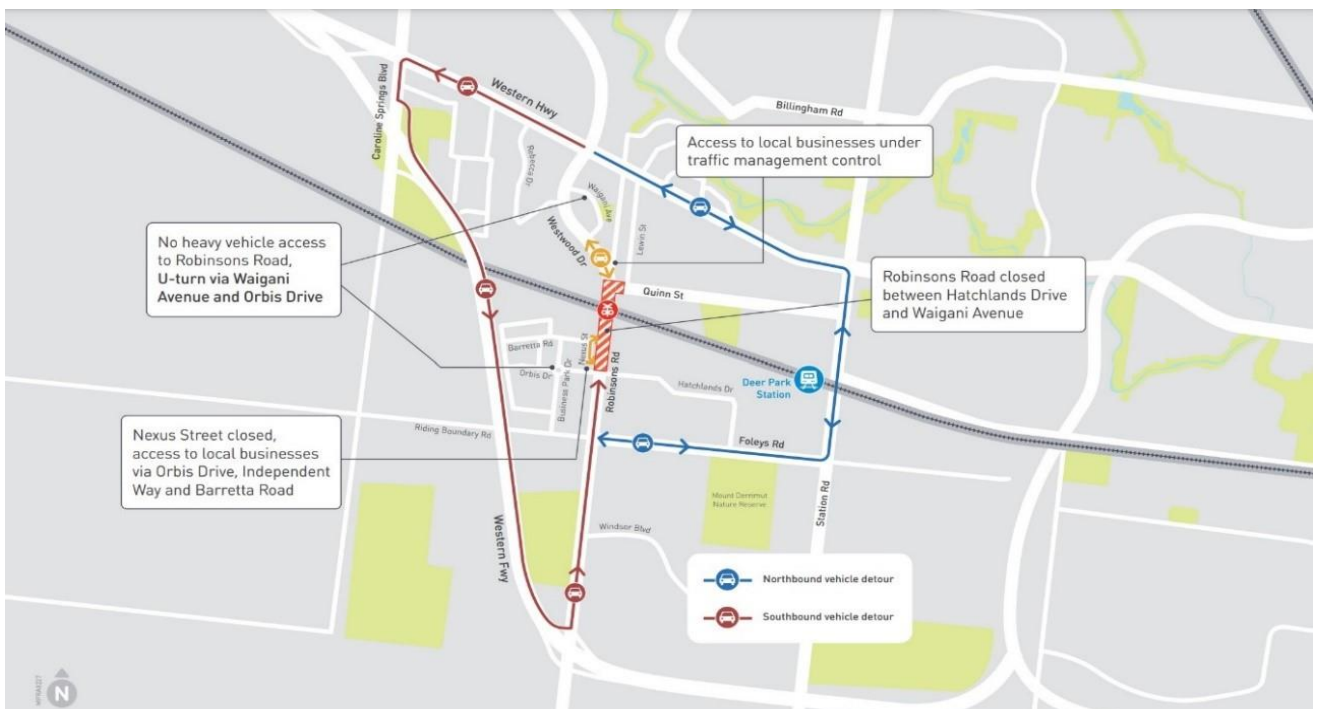

Kind regards,

**The Robinsons Road Level Crossing Removal Project Team**

### CONTACT US

levelcrossings.vic.gov.au  
contact@levelcrossings.vic.gov.au  
1800 105 105

Level Crossing Removal Project,  
GPO Box 4509, Melbourne VIC 3001

@levelcrossings



**Translation service** – For languages other than English, please call 9280 0780

Please contact us if you would like this information in an accessible format.

If you need assistance because of a hearing or speech impairment, please visit [relayservice.gov.au](http://relayservice.gov.au)



Authorised and published by the Victorian Government, 1 Treasury Place, Melbourne