

Glenhuntly Station closed

8.30pm Friday 31 March
to early August



We're busy removing level crossings

As part of Victoria's Big Build, we're making the Frankston Line level crossing free by removing all 27 of the dangerous and congested level crossings by 2029. We're building 17 new stations, improving safety, reducing congestion and allowing more trains to run more often.

The Glen Huntly Level Crossing Removal Project will remove two level crossings at Neerim Road and Glen Huntly Road by lowering the train line into a trench, as well as building a new station at Glen Huntly.

The new station will feature lowered platforms that improve safety and accessibility for locals. It will also provide better connections between public transport, shops and community spaces.

These two dangerous and congested level crossings have been fast-tracked for removal, with early construction works underway to remove the boom gates by 2023 and finish the job in 2024 – one year ahead of schedule.



Find out how these disruptions affect you

Visit ptv.vic.gov.au/frankstondisruptions
or use your phone's camera
or QR reader to scan the code



Shuttle bus service

Glenhuntly Station closure shuttle service

From **8.30pm Friday 31 March to early August**, Frankston Line trains will not stop at the closed Glenhuntly Station.

From **Monday 3 April** a shuttle bus will operate between Caulfield and Ormond to connect you to Frankston Line trains.

Shuttle buses will depart from the existing replacement bus stops on Grange Road.

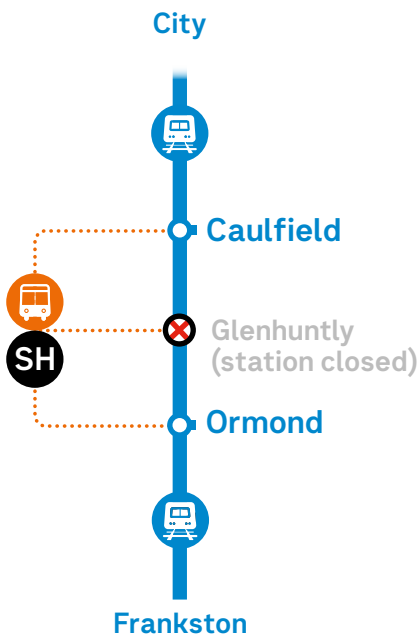



Buses replace trains

Between South Yarra and Moorabbin

8.30pm to 11.30pm Friday 31 March

6am to 11.30pm Saturday 1 April

6am to last service, Sunday 2 April

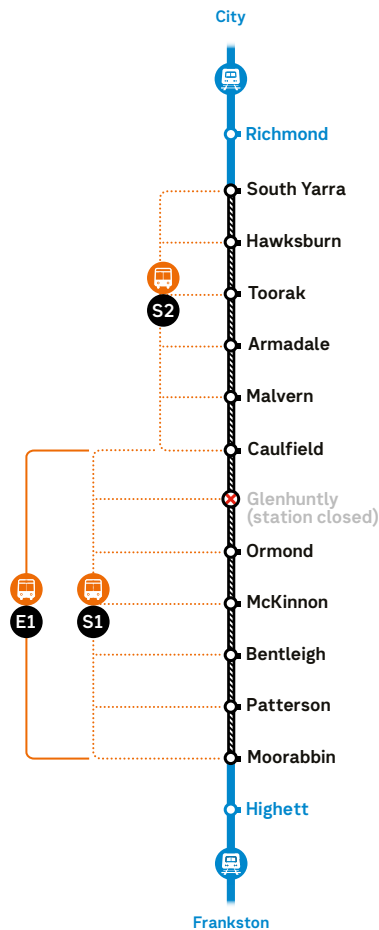

Train replacement bus services

S1 S2 Stopping all stations **L1** Limited Express **E1 E2** Express

Night works

Between South Yarra and Moorabbin

11.30pm Friday 31 March to

6am Saturday 1 April

11.30pm Saturday 1 April to

6am Sunday 2 April

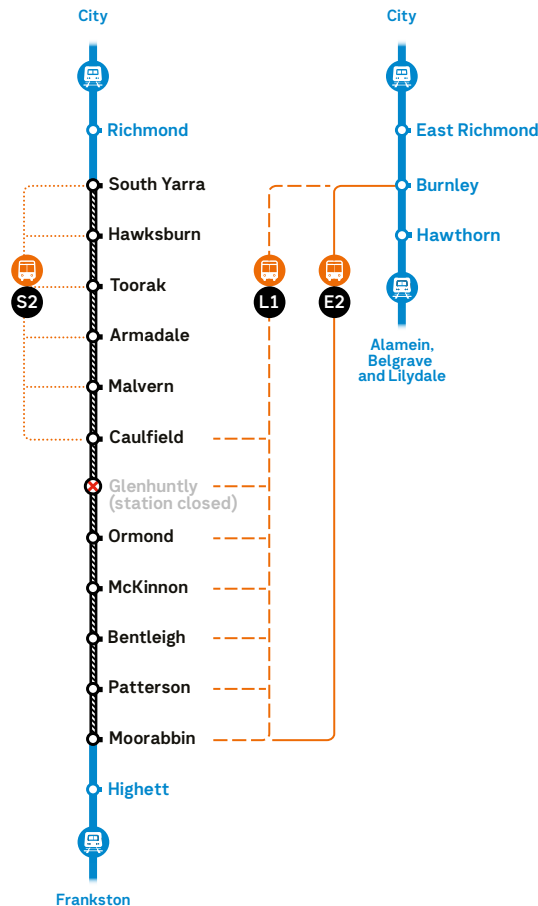

Buses also replace trains on the Cranbourne and Pakenham lines during this time.

Other disruptions on the Frankston Line

Between South Yarra and Caulfield

8.30pm Friday 24 March to

4am Saturday 25 March

8.45pm to last service, Sunday 26 March

Local travel impacts

Changes to tram services

Buses will replace Route 67 trams at stops along Glen Huntly Road, between:



Stop 53 Glenhuntly Tram Depot and Carnegie 11pm Friday 31 March to 8am Saturday 1 April

8pm Saturday 1 April to 8am Sunday 2 April

Travelling on a replacement bus

Accessibility

Most train replacement buses will be low-floor models to assist passengers.

If you need help or cannot board a replacement bus, please contact PTV prior to travelling on **1800 800 007** or speak to our staff at the bus stop for alternative transport to be arranged at no cost.

Bikes and pets

Bicycles, dogs (with the exception of animals identified by an Assistance Animal Pass) and surfboards are not allowed on train replacement buses.

Ticketing

Where possible, you should touch on and off at the beginning and end of your journey. When catching train replacement buses, you can touch on and off at your connecting train station.



Artist's impression. Subject to change.

Ticketing and station facilities

While the station is closed, station facilities and myki readers will not be available.

You should touch on and off at Caulfield and Ormond stations. New myki card purchases or myki top ups can be made at Caulfield or Ormond stations.

To find your nearest retail outlet, go to ptv.vic.gov.au/myki



Planning your journey

We're here to help you travel during major construction and get you to and from your destination as quickly and easily as possible. We'll continue to keep you updated on works and advise you of the best way to travel.

Plan your journey at ptv.vic.gov.au
or call **1800 800 007**.

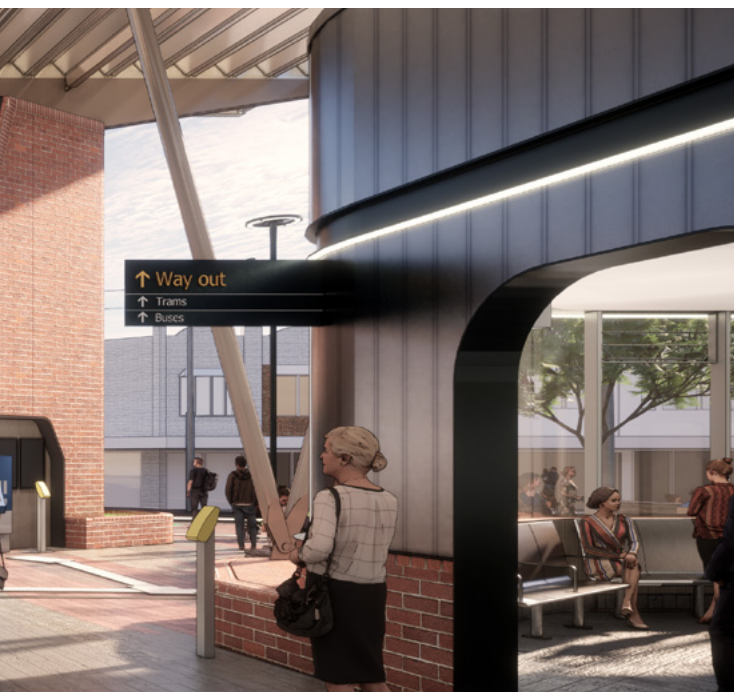

For more information visit ptv.vic.gov.au
or call **1800 800 007**.

If you're deaf, or have a hearing or speech impairment, contact us through the National Relay Service – for more information, visit relayservice.gov.au



For information in other languages:

普通話	9321 5454	廣東話	9321 5441
Italiano	9321 5444	ਪੰਜਾਬੀ	9321 5445
Ελληνικά	9321 5443	हिन्दी	9321 5442
Việt-ngữ	9321 5449	සිංහල	9321 5446
عربي	9321 5440	Español	9321 5447

If your language isn't listed visit ptv.vic.gov.au/languages or call **9321 5450**.