

24 January 2024

Good afternoon,

**We're powering ahead to make the Lilydale Line level crossing free and getting rid of more boom gates on the Belgrave Line in 2024, a year ahead of schedule.**

In late 2023, we wrote to you about buses replacing trains on the Belgrave and Lilydale lines as well as disruptions in the Croydon and Lilydale area starting in January.

We are now writing to remind you of these upcoming disruptions and to provide you with more detailed information on the way you will need to travel in the local area.

Students, parents, and school staff will need to plan ahead and allow extra travel time while works take place.

**Buses replace trains on the Belgrave and Lilydale lines**

To support these works, buses will replace trains on sections of the Belgrave and Lilydale lines from **8.30pm Tuesday 30 January to April 2024**, including:

<b>Buses replace trains between</b>	<b>When</b>
Blackburn, Belgrave, and Lilydale	8.30pm Tuesday 30 January to 8.30pm Friday 2 February
Parliament and Belgrave	Saturday 3 February to last service Sunday 4 February
Ringwood and Bayswater	Monday 5 February to mid-March
Ringwood and Belgrave	Mid-March to April
Blackburn, Belgrave, and Lilydale	Mid-March to April

Stay up to date with all your Belgrave, Lilydale and Alamein lines disruptions by visiting [ptv.vic.gov.au/disruptions/bel-lil-alm](http://ptv.vic.gov.au/disruptions/bel-lil-alm)

**Road closures**

While works take place, there will also be road closures in the local area, including:

- Coolstore Road, Croydon permanently closed at the level crossing in **Autumn 2024** with new road connections opening by **Spring 2024**.
- Cave Hill Road, Lilydale permanently closed at the level crossing from **Wednesday 24 January**, with a new pedestrian underpass opening later in **Spring 2024**.

There will also be intermittent traffic impacts on local roads to support level crossing removal works.

### Croydon Station temporarily closed

From **Tuesday 30 January until Spring 2024**, Croydon Station will be temporarily closed. Please refer to the table below for further details.

What is happening	Date and Time	Changes/alternatives
<b>Croydon Station temporarily closed</b>	Tuesday 30 January until Spring 2024	<ul style="list-style-type: none"> <li>When the station is closed all facilities, including myki services and the Parkiteer will be unavailable. Alternative bike hoops are available near the park at 99 Main Street, Croydon. New myki card purchases, or balance top ups can be made at <a href="http://ptv.vic.gov.au/myki">ptv.vic.gov.au/myki</a>, neighbouring stations, or nearest retail outlets.</li> <li>The new Croydon Station will open by <b>Spring 2024</b>.</li> </ul>
<b>Croydon Station shuttle bus service</b>	Tuesday 30 January until Spring 2024	<ul style="list-style-type: none"> <li>While the station is closed, Lilydale Line trains will not stop at Croydon Station.</li> <li>A shuttle bus service will be in place connecting passengers from Croydon to train services at Ringwood East and Mooroolbark stations.</li> <li>The shuttle bus service will be available at the train replacement bus stops on Devon Street, Croydon.</li> </ul>

### Pedestrian access changes at Coolstore Road, Croydon

During this time, there will be changes to the way school students, parents/guardians and school staff move around the Croydon area. Please refer to the table below for these changes.

Changes	Date and Time	Alternatives
Pedestrian access changes	<b>Tuesday 30 January to Friday 9 February</b> , the Coolstore Road, Croydon pedestrian level crossing will be temporarily closed.	To cross the train line, students, parents, and staff can use the pedestrian crossings at: <ul style="list-style-type: none"> <li>• Kent Avenue and Main Street (near Vinnies at the roundabout)</li> <li>• Alto Avenue and Main Street (west of Croydon Station)</li> <li>• the pedestrian walkway between Croydon Station and Wicklow Avenue (adjacent to the works area)</li> </ul>
	<b>Tuesday 30 January until Spring 2024</b> , the pedestrian walkway through the closed northern car park at Croydon Station will permanently close.	To cross the train line, students, parents, and staff can use the pedestrian level crossings at: <ul style="list-style-type: none"> <li>• Coolstore Road, Croydon (from Saturday 10 February)</li> <li>• Kent Avenue and Main Street (near Vinnies at the roundabout)</li> <li>• Alto Avenue and Main Street (west of Croydon Station)</li> <li>• The pedestrian walkway between Croydon Station and Wicklow Avenue (adjacent to the works area)</li> </ul>

**Map of pedestrian access changes at Croydon Station**

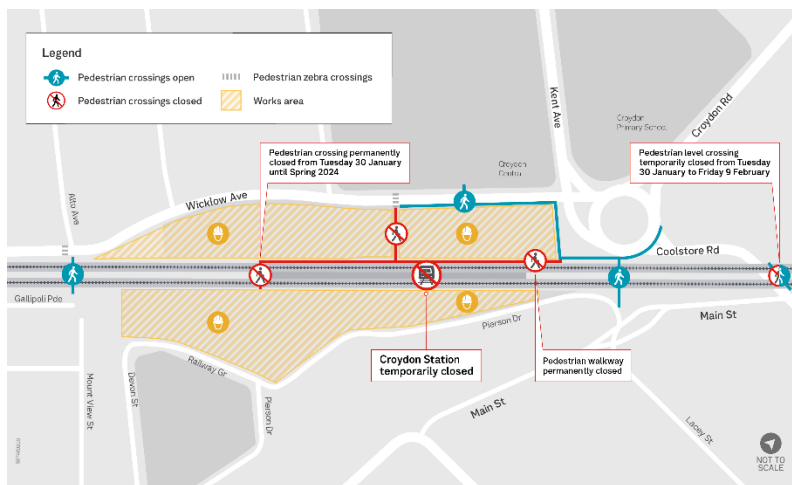

### Changes to the way you travel in Lilydale

While buses are replacing trains, there will also be pedestrian access changes at Cave Hill Road, Lilydale. Please refer to the table below for these changes.

Pedestrian level crossing temporarily closed	Date and Time	Pedestrian detour
Cave Hill Road, Lilydale	<ul style="list-style-type: none"> <li>From <b>Tuesday 30 January to Saturday 3 February</b>, the pedestrian level crossing on Cave Hill Road, Lilydale will be temporarily closed.</li> </ul>	<ul style="list-style-type: none"> <li>A pedestrian detour will be in place via Cave Hill Road, John Street and William Street East.</li> </ul>

### Map of pedestrian access changes at Cave Hill Road, Lilydale

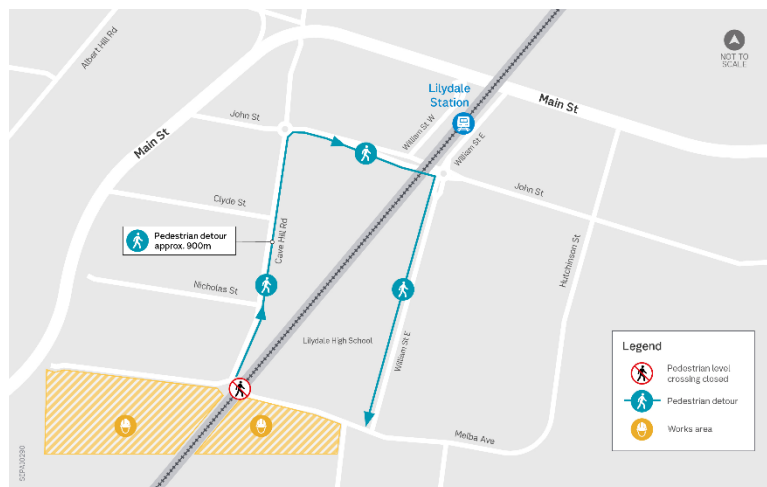

### Works in the area

While trains are not running, we will work day and night shifts to:

- Demolish Croydon Station, including the platforms and removing redundant station services
- Trench and install underground and overhead rail equipment including construction of hardstand for construction equipment and machinery at Cave Hill Road
- Continue with building bridge foundations
- Undertake rail signalling works
- Relocate underground utility services, including water
- Investigate services.

### Helping students navigate disruptions

There are several ways we'll help students, parents/guardians and staff get to and from school safely, including:

- Providing interactive detour maps on our website
- Clear, signed pedestrian pathways around construction zones
- Traffic management crews on site to safely direct traffic and monitor congestion
- School updates, such as this email, to provide information that can be used in school communication channels to parents and guardians
- Opportunities for students to get involved in the project through learning activities and career talks
- Clear, advance notice of disruptions online, via email and SMS, and in local letterboxes.

We're also available to hold meetings with parents/guardians at schools to go through these disruptions in more detail.

### More information

Please find enclosed a brochure regarding the train replacement bus services and changes in the area. We recommend you include this information in your school communication channels to inform students, parents, and staff.

If you have any questions about this information, please contact the Level Crossing Removal Project on **1800 105 105** or via email at [contact@levelcrossings.vic.gov.au](mailto:contact@levelcrossings.vic.gov.au).

For regular information about the progress of this project, sign up for email updates. You can also sign up for SMS alerts by texting 'Coolstore' to **0438 942 094**.

Kind regards,

Coolstore Road Level Crossing Removal Project Team

[levelcrossings.vic.gov.au](http://levelcrossings.vic.gov.au)

