

Level 5
Bunjil - Eagle

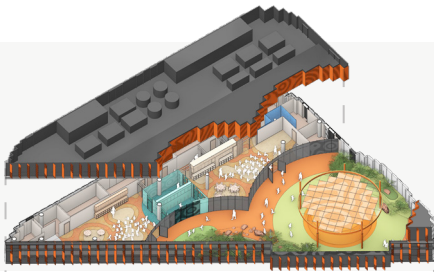

- Kindergarten reception
- Two children's rooms
- Children's bathroom / toilets
- Kitchen
- Accessible / staff toilet
- Laundry
- Staffroom / kitchenette
- Outdoor learning space

Level 4
Wurru - Sky

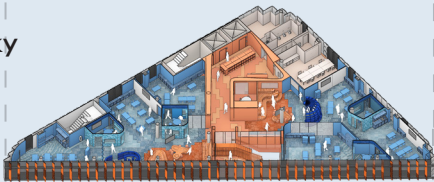

- Six general purpose classrooms
- Four breakout rooms
- Shared reading area, storage, and mini library
- Shared learning space
- Shared landing (welcome landing)
- Meeting room
- Staff work space
- Staff and student toilets

Level 3
Biik Biik - Land



- Six general purpose classrooms
- Four breakout rooms
- Shared reading area, storage, and mini library
- Shared learning space
- Shared landing (welcome landing)
- Meeting room
- Staff work space
- Staff and student toilets

Level 2
Wurneet - Waterways

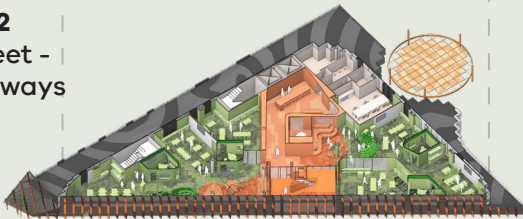

- Six general purpose classrooms
- Four breakout rooms
- Shared reading area, storage, and mini library
- Shared learning space
- Shared landing (welcome landing)
- Meeting room
- Staff work space
- Staff and student toilets

Level 1
Wilam - Home



- Outdoor play space
- Shared landing (welcome landing)
- Canteen
- Consulting/meeting room
- Three general purpose classrooms
- Two breakout rooms
- Shared learning area
- Staff work space
- Staff, student toilets and cleaner's storage
- Specialist teaching spaces
- Food technology
- Art room

Lower ground
Teerrendeerr - Emu's egg



- Basketball court
- Community hub
- Spectator seating
- Change rooms
- Gymnasium storage
- Music room
- Performance and gathering space

Ground
Wominjeka - Welcome



- Outdoor play space
- Molesworth Street entrances
- Hardwicke Street play space entry
- Future lane entrances
- Staff and student toilets
- Administration area, library
- Covered public meeting space

North Melbourne Primary School
(new campus)