



9 September 2021

Dear Resident/Business,

Maroondah Highway level crossing removal project – construction blitz starting Friday 10 September

The Maroondah Highway level crossing removal project has been designated a critical state infrastructure project under the latest restrictions. Work is continuing safely with strict COVIDSafe plans in place and we continue to comply with all directions from the Chief Health Officer.

We are managing the number of staff attending our worksites, as well as implementing preventative measures to ensure community safety. Safety measures across the site include temperature screening, additional protective equipment including masks, daily health screening of workers, enhanced cleaning, staggered shifts and break times, and physical distancing. For more information about coronavirus (COVID-19) visit [coronavirus.vic.gov.au](https://www.coronavirus.vic.gov.au).

This works alert provides an overview of our upcoming construction blitz, changes to the way you will travel in September and October 2021 and our **planned construction blitz starting this Friday 10 September 2021**.

Planned construction blitz (10 September – 25 October)

The boom gates at Maroondah Highway will be gone and the new Lilydale station will be open on 25 October, months ahead of schedule. To remove the boom gates and build the new station and rail bridge, we will be working around the clock between Friday 10 September and Monday 25 October. During this period, workers will be on site with cranes, trucks, excavators, light towers and other large construction machinery between Melba Avenue and Lilydale Station and on the Maroondah Highway, John Street and William Street East and West.

To complete the new rail bridge and build the new Lilydale Station, we will close both John Street and Maroondah Highway (at the level crossing) from 9pm Friday 10 September until 6am Saturday 9 October. Local access for traders and residents will be maintained with traffic management in place.

Changes to the way you travel (September and October 2021)

To complete these works, there will be some planned changes to the way you travel.

Transport	Planned travel changes
Lilydale line services	<p>From 8:30pm Friday 10 September to last service Sunday 24 October, buses will replace trains between Ringwood and Lilydale. Please allow extra travel time. Mooroolbark and Lilydale stations will be closed until Sunday 24 October 2021.</p> <p>Train replacement buses will drop off and collect passengers on the Maroondah Highway service road, outside Yarra Valley Fish and Chips. Five accessible car spaces and the taxi rank have been relocated near the train replacement bus stop.</p>
Lilydale Station	<p>From 8.30pm Friday 10 September to Sunday 24 October 2021, Lilydale Station will be closed. Both the western and eastern car parks (on either side of the level crossing) are closed from Monday 6 September, with alternative parking available at the Lilydale Showgrounds and the Lilydale Outdoor Pool.</p>

New myki card purchases, or balance top ups can be made at ptv.vic.gov.au/myki, via the PTV app or at neighbouring stations. To find your nearest retail outlet, go to ptv.vic.gov.au/myki

Maroondah Highway and John Street

From **9pm Friday 10 September until 6am Saturday 9 October 2021**, Maroondah Highway and John Street will be closed in both directions.

- Road users are advised to follow signage and use Cave Hill Road, Beresford Road and Anderson Street to continue towards their destinations safely.
- Oversized vehicles and trucks should use Mount Dandenong Road to avoid works near the level crossing.

From Saturday 9 October to Monday 25 October, Maroondah Highway will be reduced to one lane in each direction over the level crossing to safely construct the new Lilydale Station.

William Street East & West

William Street East and West will be closed until Monday 25 October to safely construct the new Lilydale Station. Pedestrian access will be maintained during this time, with traffic management in place to safely guide pedestrians around construction zones.

From Friday 10 September to Tuesday 21 September, there will be limited vehicle access to William Street East from the Maroondah Highway service lane to construct the new Maroondah Highway/William Street East intersection.

Pedestrian crossing on Maroondah Highway

The pedestrian crossings over the railway line on the Maroondah Highway will be closed until Monday 25 October. To safely guide pedestrians across the railway line, there will be various pedestrian detours in place, with signage and traffic management to guide you to your destination.

Buses, taxis and accessible parking

- **Taxi rank and accessible parking:** The taxi rank and 5 accessible car spaces have been relocated to the service lane (opposite The Professionals) on Maroondah Highway.
- **PTV bus services:** Bus routes 663, 670, 673, 676, 677, 679, 680, 683, 684, 685 and Telebus 1 will still operate out of Lilydale Station bus interchange. To safely allow for some construction activities, bus route 683 may at times operate on the service road on Maroondah Highway.
- Please follow all signage in place during this period. Passengers who use these bus services should allow an additional 15 minutes travel time.

Assistance for passengers with additional needs

Wheelchair Accessible Taxis will be on standby at the following stations from **Saturday 11 September to Sunday 24 October:**

- **Ringwood:** from 8am to 9.30pm on weekends and 6.30am to 10.30pm on weekdays
- **Lilydale:** from 7am to 5pm on weekends and 6am to 9pm on weekdays
- On public holidays, the Wheelchair Accessible Taxis will be on standby at Ringwood and Lilydale as per the weekend times shown above
- **Blackburn:** a Wheelchair Accessible Taxi will be on standby on Saturday 9 October from 7am to 10pm and Sunday 10 October 8am to 9.30pm.

Please speak to the customer service staff at your replacement bus stop or station staff to organise a taxi. Most train replacement buses will be low-floor models to assist passengers. To check if your mobility aid can fit on the buses, we recommend contacting PTV prior to travelling on **1800 800 007** or search 'accessibility' on the PTV website.

If you are deaf, or have a hearing or speech impairment, you can contact us directly or through the National Relay Service and request to call **1800 800 007**.

CONTACT US

levelcrossings.vic.gov.au
contact@levelcrossings.vic.gov.au
 1800 105 105

Level Crossing Removal Project,
 GPO Box 4509, Melbourne VIC 3001



@levelcrossings



Translation service – For languages other than English, please call 9280 0780

Please contact us if you would like this information in an accessible format.

If you need assistance because of a hearing or speech impairment, please visit relayservice.gov.au



What to expect?

- From 9pm Friday 10 September to 6am Saturday 9 October, John Street and Maroondah Highway (at the level crossing, near Lilydale Station) will be closed in both directions.
- From 8:30pm Friday 10 September to last service Sunday 24 October, Lilydale Station will close and buses will replace trains between Ringwood and Lilydale. Train replacement buses will collect and drop off passengers on the Maroondah Highway service road, near Yarra Valley Fish and Chips.
- Planned 24/7 works and road, rail, bus and pedestrian disruptions around the Maroondah Highway level crossing (between Melba Avenue and Beresford Road) from Friday 10 September to Monday 25 October 2021.
- Increase in travel times, with road disruptions in place around Maroondah Highway, buses replacing trains between Ringwood and Lilydale and local road and pedestrian detours.
- Increase in construction noise and activity, with construction vehicles, large equipment and works being undertaken in the rail corridor between Melba Avenue and Beresford Road.
- Increase in construction vehicles along Maroondah Highway, John Street, William Street East and West and other local streets.
- Traffic management will be in place to safely assist road users and pedestrians to their destination.

Keeping in touch

You can register to receive disruption information via text message. Simply text the word **Maroondah** to **0429 913 671** to sign up to alerts for traffic and construction impacts for the Maroondah Highway Level Crossing Removal Project.

Alternatively, you can sign up to our email updates at www.levelcrossings.vic.gov.au/contact/subscribe, so we can continue to keep you informed about our works in your area. Our team is regularly updating our website and social media channels for both level crossing removals.

Every effort will be made to complete the works in the time outlined above, however these dates are subject to change. For more information on upcoming disruptions, please visit <https://levelcrossings.vic.gov.au/disruptions>.

If you have any further questions or queries, please do not hesitate to contact the LXP 24/7 Contact Centre on **1800 105 105** or contact@levelcrossings.vic.gov.au.

Kind Regards,

The Maroondah Highway Level Crossing Removal Project Team

CONTACT US

levelcrossings.vic.gov.au
contact@levelcrossings.vic.gov.au
1800 105 105

Level Crossing Removal Project,
GPO Box 4509, Melbourne VIC 3001

     @levelcrossings



Translation service – For languages other than English, please call 9280 0780

Please contact us if you would like this information in an accessible format.

If you need assistance because of a hearing or speech impairment, please visit relayservice.gov.au



Authorised and published by the Victorian Government, 1 Treasury Place, Melbourne

Maroondah Highway and John Street closures: detour map for upcoming construction blitz (10 September – 25 October)

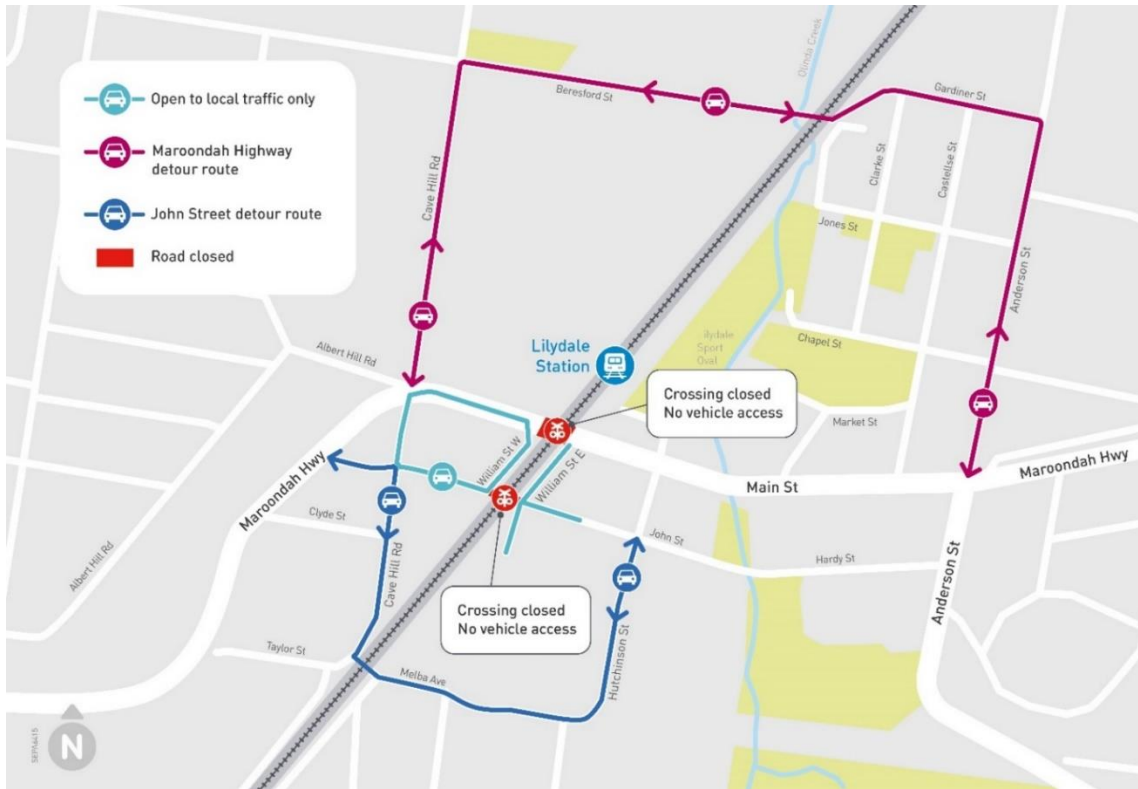

CONTACT US

levelcrossings.vic.gov.au
 contact@levelcrossings.vic.gov.au
 1800 105 105

Level Crossing Removal Project,
 GPO Box 4509, Melbourne VIC 3001

     @levelcrossings



Translation service – For languages other than English, please call 9280 0780

Please contact us if you would like this information in an accessible format.

If you need assistance because of a hearing or speech impairment, please visit relayservice.gov.au



Authorised and published by the Victorian Government, 1 Treasury Place, Melbourne