

# Downloading the App

## App Store and Google Play

You will find the nPortal app available in the Apple App store or Google play store. The App can be found by searching "nForma for Parents". The app will be available to be downloaded for free.

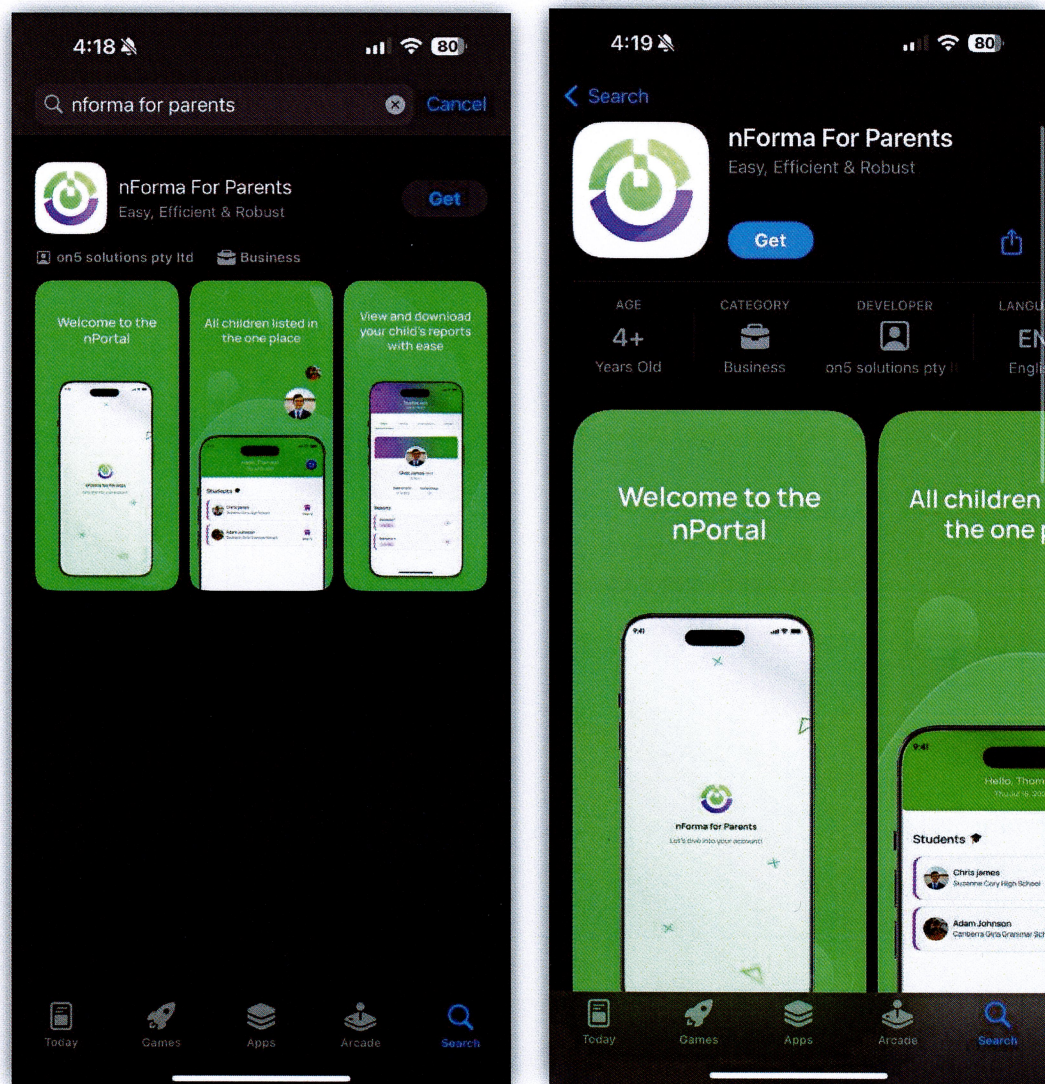



# Logging in

## Nice and simple

Logging into the nPortal App is nice and simple. There are multiple ways that you can login to the App. The main thing to remember is to ensure that the email being used to login, is the email that is linked with the school. If you are unsure of which email address is linked to the school, you can ask the school and they can inform you of it.

1. Continue with Google – If your Gmail account is linked with the school, you can login through that button
2. Continue with Apple – If the email account linked to your apple account is the same as the one linked to the school, you can use that button
3. Email and Password – If you have a custom email domain, Hotmail, etc. you can type that in and login. If you have never logged in before, you will need to activate your account. To activate your account, click "forgot password?". This will then request an email address to send the password reset to. Input the email and submit. You will then receive an email with instructions. Once done, you can use those login details and login to the app.

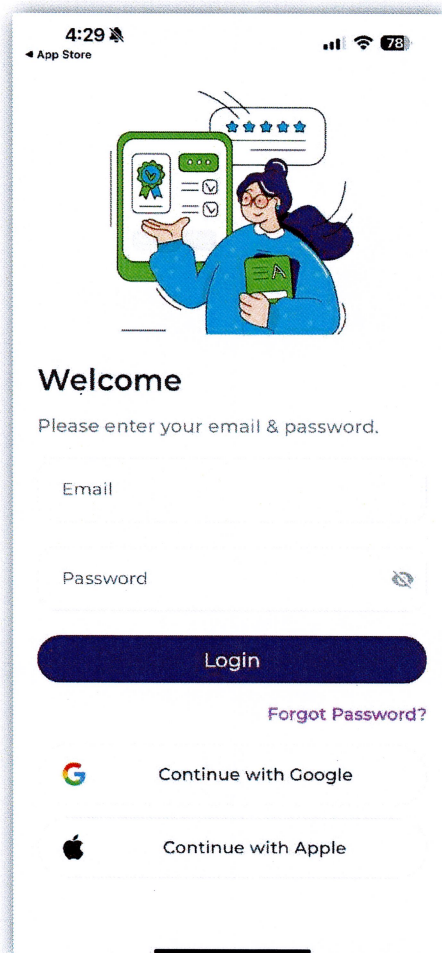

# Medical

Our medical module is a great way for you to keep schools up to date with your child's health conditions and medical history. The module acts as an interface where you and the school can upload any health-related data. Whether it be names of doctors to current medication the child is prescribed to, everything will be found there.

To access the medical module, select the child, then the medical tile. Fill in all the fields that relate to your child. The medical module on the app includes:

- Emergency contact details
- Medical Contact
- Health Condition
- Medication
- Medical Documents
- Other Medical e.g Medicare number

3:05 62

Sophia Anderson  
Year 1 / HG 2A

Medical Contact +  
*Medical contacts are not available*

Health Condition +  
*Health conditions are not available*

Medication +  
*Medications are not available*

Medical Documents ↑  
*Documents are currently unavailable.*

Other Medical

3:05 62

Add Medical Contact

"Medical contact" generally refers to the interaction between a patient and a healthcare provider, such as a doctor, nurse, or therapist.

Name

Address

Profession

Contact Number

Submit Cancel