



ST FINBAR'S PRIMARY SCHOOL

FACILITIES MASTERPLAN
APRIL 2021

Prepared by



INTRODUCTION

In 2020 Preston Lane Architects were commissioned to undertake a facilities masterplan for St Finbar's Primary School. The aim of this work is to provide a framework for future development and capital works decision making, to better connect the built environment, to the teaching and learning methods of the school.

The masterplan identifies a strategic list of potential projects, establishing an agenda for short, medium and long term upgrades to the facilities at the school. It is important to note that this masterplan is specifically focused on the school facilities in response to the current established pedagogic direction of the school.

FACILITIES MASTERPLAN PROCESS

The initial work involved a review of historical development information available from the school archives, along with a detailed site visit and review of the existing school facilities. This work culminated in a consolidated existing school site plan (see pages 5 and 6) identifying the spatial areas of the school.

In 2021 the school leadership undertook a survey of the staff and parent community to gain an understanding of their perspective on the current and future facilities of the school. This was followed by a focused workshop with the School Advisory Board, the School Principal Mr Pat Berlinger and Deputy Principals Mrs Peggy McDonald and Mr Steele Anderson.

Survey Questions and discussions were focused on the following key areas:

1. Inside Spaces / Classrooms and General Facilities
2. Outside Spaces
3. General School Facilities Organisation – Layout & Planning
4. Staff Facilities
5. Access / Way Finding
6. Safety and Security
7. Sustainability
8. School Technology

This information was then collated (see appendix 1) forming the basis of recommendations for future development.



GUIDING PRINCIPLES OF THE SCHOOL

VISION STATEMENT

St Finbar's is a Catholic Primary School Community which aims to provide a safe, supportive, and dynamic learning environment in which each member is respected and nurtured.

MISSION STATEMENT

St. Finbar's is a school where:

- All members are nurtured to grow in their Catholic Faith and Spirituality with a focus on our Catholic Social Teachings and Social Justice.
- Students are encouraged and supported to participate fully in an ever-changing global community, supported by a curriculum which meets their individual learning needs.
- We value each member as an individual whilst nurturing their social and emotional wellbeing.
- Structures and practices are put in place to ensure that all members of the community have the opportunity to grow.
- Positive partnerships between school, home and parish are fostered to strengthen our relationships and promote active community involvement.



ST FINBAR'S SCHOOL HISTORY

SCHOOL HISTORY

St Finbar's Parish, Primary School is situated beside the historic St Finbar's Church on the corner of Centre Road and Nepean Highway, East Brighton.

Formally known as St Patrick's Parish of Little Brighton, the church was opened in a newly erected weatherboard building on April 30 1848, with Mass. The school shared this building with the church for three months and in June 1848, St Finbar's School was opened in another small, wooden building on the site. With the development of plans for a Melbourne Cathedral, the Archbishop requested that the name Patrick be given to this project; hence St Patrick's Little Brighton took the name of St Finbar's - a truly Irish saint. The weatherboard church and school, 'the first Catholic Church erected in the suburban area of Melbourne' have long since disappeared and have been replaced by the present buildings. None of the original buildings remain as many of them were demolished during the 1970s with the widening of Nepean Highway.

The school was originally founded and staffed by lay teachers. Between 1906 and 1908, the Presentation Sisters taught in the school. They then returned to run the school in 1925 and remained until 1974. Due to

decreasing numbers and a redefining of their mission, the Sisters handed on the tradition of quality education into the hands of lay administration and teachers and this legacy lives on today. (2019 Annual School Report)

RECENT BUILDINGS AND FACILITIES HISTORY

The school is very well-equipped with spacious, up to date classrooms and a number of specialist learning areas. Facilities include the following:

- Library / Performing Arts Room
- Visual Arts Centre
- Administration and Staff Facilities
- 5 Meeting Rooms
- Uniform Shop
- Playground spaces with a sustainable garden, an adventure garden and open playing spaces
- Multiple Water Tanks and Solar Panels
- Multi-purpose Hall
- Tuck shop/Canteen
- Out of school hours Care Facility



In 2009, as part of the Federal Government's 'Building the Educational Revolution Program' (BER), St Finbar's received a grant of \$2.5 million, which was used to construct the Multi-purpose Hall and fencing.

In January 2010, a major building program was completed that included the expansion of learning spaces over a second level. The School Building Program was self-funded and has incurred a debt of \$3.2 million to be repaid over 15 years, the interest of which is paid by the Government.

In 2017, the Mary Clare playground was refurbished with the addition of the running track and relocation of the basketball court to a more central location.

In 2018, the Thomas Sherry playground was re-asphalted with some slight modifications which enabled 2 full multi-purpose courts with multiple line markings (Basketball/Netball & Soccer/Netball).

Security cameras were added in 2018 and 2019 to the external building and public internal areas for added security and safety.

In 2019 and 2020 all classroom furniture was replaced with new contemporary furnishings with the assistance of the generous Parents and Friends Association under the direction of the School Advisory Board.

EXISTING SCHOOL SITE PLAN

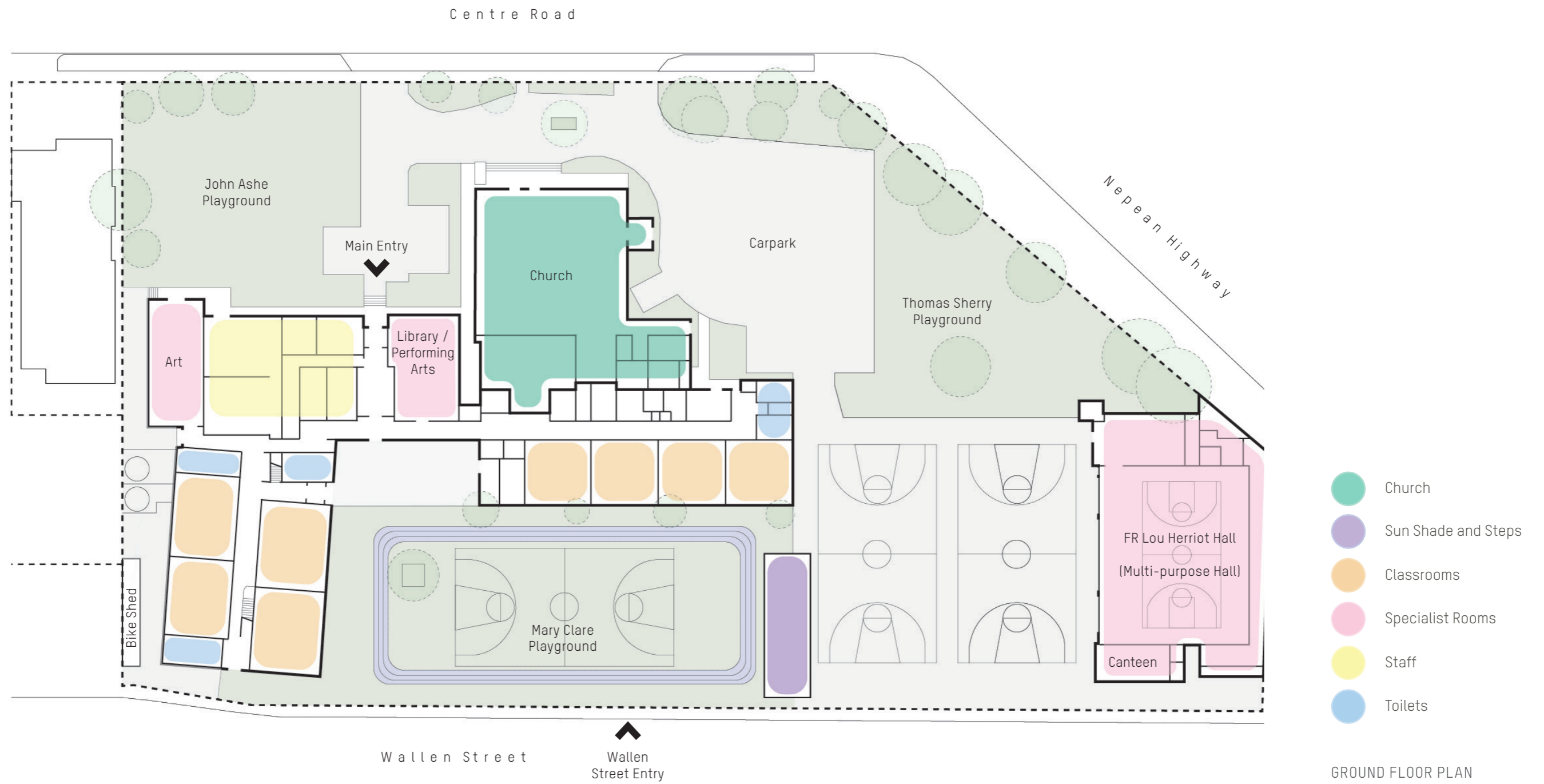

GROUND FLOOR PLAN



EXISTING SCHOOL SITE PLAN

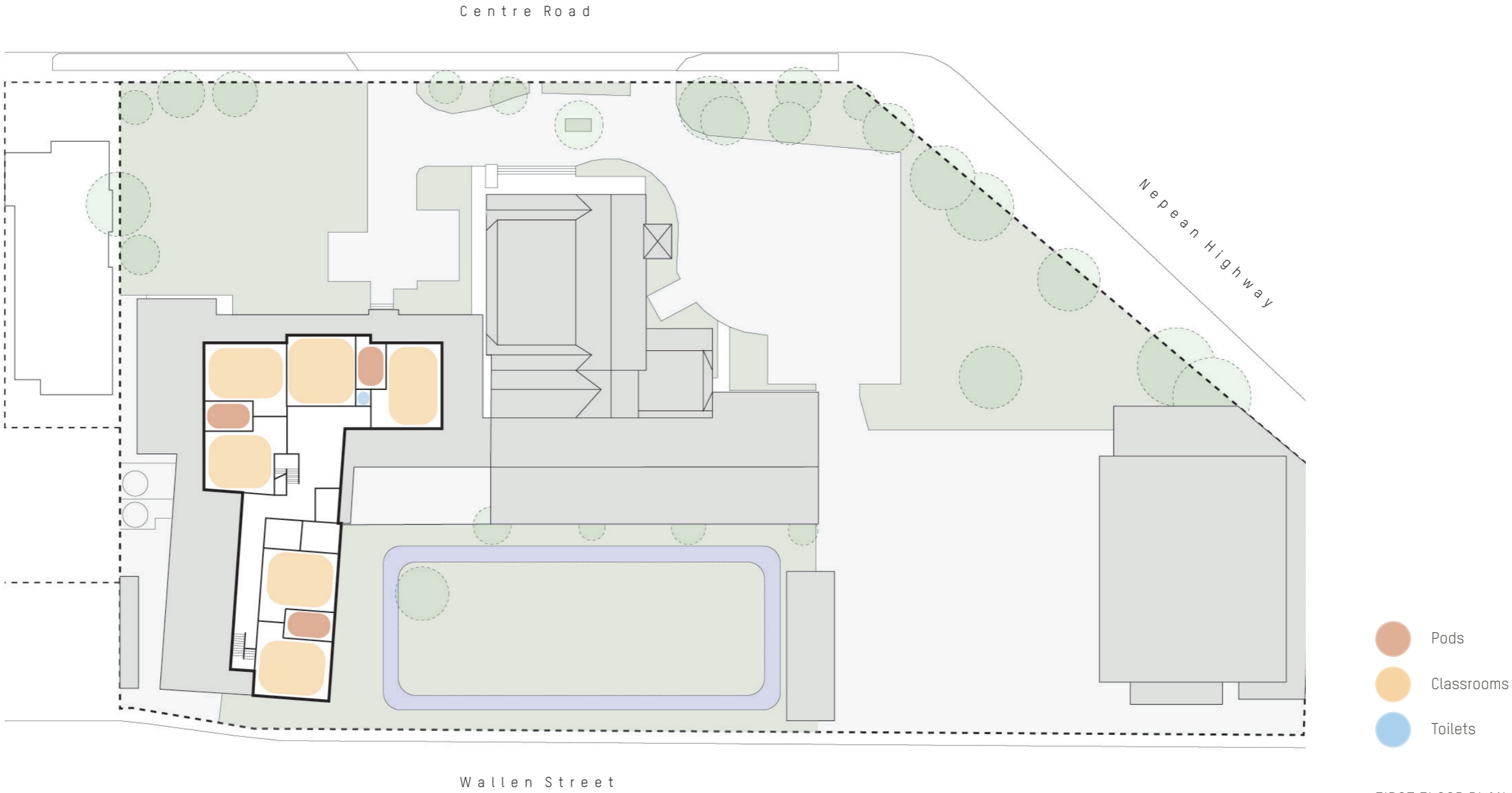

- Pods
- Classrooms
- Toilets

FIRST FLOOR PLAN



FUTURE PROJECTS DEVELOPMENT SUMMARY

This table outlines a list of future potential upgrade and development projects identified from the data collected in the survey and the School Advisory Board workshop.

This information has established an agenda and been organised into high, medium, and low priorities projects, along with low, medium and high cost categories.

Overwhelmingly, the data collected provided positive feedback on the existing school facilities.

As the table identifies there are several projects that are low cost and easily achievable, of which some are already underway.

There are also a number of more significant projects that have been identified and are discussed in the following summary.

	Low Cost	Medium Cost	High Cost
High Priority			
Air Conditioning to Multi Purpose Hall		■	
Lift between Ground and First floor Classrooms			■
Upgrade Thomas Sherry Playground equipment		■	
Review general School wayfinding	■	■	
Review Sustainability Waste Program - compost/recycling/rubbish bins etc	■		
General painting and carpet tile upgrade to stairs	■		
Upgrade of interactive whiteboards		■	
Improve School wide Wi-fi coverage	■		
Review integration of current sustainability facilities with student teaching - solar/water etc	■		
Medium Priority			
Review classroom 'pod' design and layouts/furniture		■	
Dedicated storage facilities for out of school sporting clubs so that the hall has better storage for school PE and PMP equipment		■	
Dedicated Library Room			■
Dedicated Performing Arts Room			■
Dedicated LOTE Room			■
Medium Sized meeting space (similar to library size but smaller than hall) - upstairs		■	
Upgrade main entry doors to electric sliding to make safer/easier access		■	
Review Archive Room - size and location	■		
Provision for undercover access to all areas of the school			■
Investigate provision of upper level toilets - staff and students			■
Provide school accessible toilet - upstairs?		■	
Improve senior upper level breakout space - custom design and furniture		■	
Review zoning of dedicated outdoor play areas - i.e. proximity to classrooms - could be improved with better wayfinding	■		
Low Priority			
New Shared office for specialist staff		■	
Investigate larger internal doors/connections between Foundation and Grade 1 rooms		■	
Provision of additional undercover areas while students transition before and after school		■	■
Investigate opening current Visual Art room to John Ashe Playground so it has better connection with outside	■		
Year 2 classrooms very cold - review as part of any potential redevelopment		■	
Review glazing and shading of Year 5 and 6 upper level classrooms - consistently hot		■	■

SUMMARY OF KEY FINDINGS

1 - DEDICATED SPECIALIST ROOMS AND UPPER-LEVEL TOILETS

The survey feedback indicated that the school could be improved by providing dedicated specialist classrooms including a Performing Arts, and a LOTE (Languages Other Than English) Room.

It was also evident that the current teaching space to the east of the main entry that is shared by the Library and Performing Arts is not the best use of this space, with both these specialty learning areas having to compromise to allow each of them to function. This current room could provide adequate space for a dedicated Performing Arts room. This room is ideally located away from classrooms (noise) and adjacent the main entry for good access for incursions. A new dedicated Library would then need to be constructed.

The current upper level is not serviced by any student toilets and there is one very small and not very functional staff toilet that was created from an existing cleaner's room. The school also does not currently have any accessible toilet facilities.

Given the tight constraints of the current school site, with the lack of available ground level space to expand

the school without the loss of outdoor space, there appears to be two possible areas that could facilitate a building extension catering for new specialist classrooms and toilets.

These areas are identified on the diagrams adjacent and are located above the current Year Two classrooms (option A) or above the current Foundation and Year 1 classrooms (Option B). Both suggested locations will require further detailed investigation into their respective feasibility.

Option A would appear to be a simpler proposition and could potentially cater for a new dedicated Library and Multipurpose room that could be shared between LOTE and also used as a medium size meeting room. There would also be space for upper-level toilets including an accessible toilet. These new toilets would sit over the existing lower-level toilets reducing plumbing complexity in construction. The proximity to the existing upper-level corridor could easily facilitate a glazed interface between the new rooms and this space, providing efficient access to the new rooms.

Option B could provide for a larger footprint of building than Option A and could include dedicated rooms for the Library, LOTE, Medium size meeting

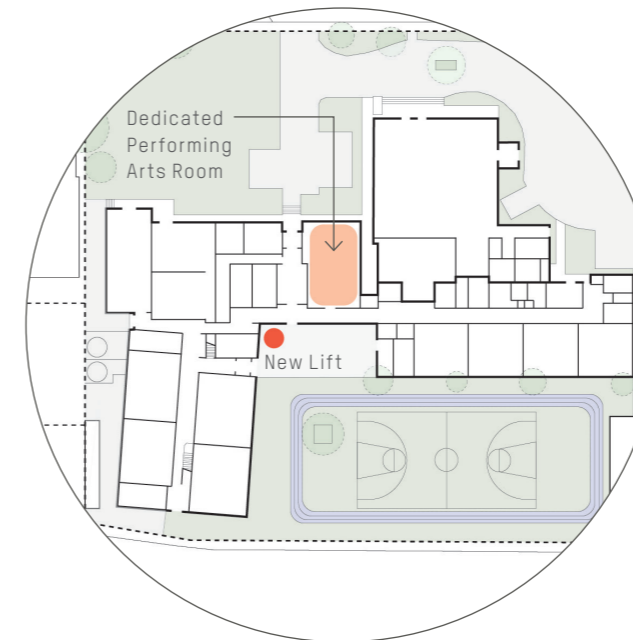

Ground Floor Plan

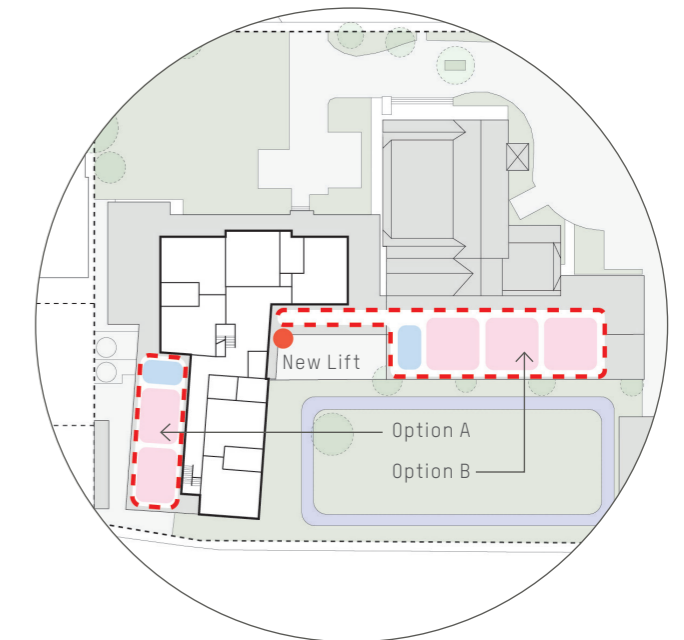

First Floor Plan

room and toilet facilities including an accessible toilet. This option would require consideration of building mass and its impact on the Mary Clare playground, and, as the important heritage interface with the existing church building. This option would also rely on a linking section of corridor to be constructed to the south of the Eastern Grade 6 classroom.

Both options would have impact on the running of the school during construction periods, however Option A would appear to have a lesser impact and would primarily affect the two classrooms below. These classrooms could be temporarily relocated during the construction works.

2 - NEW LIFT

The consultation provided consistent feedback for the prioritisation of a lift installation between ground and first floor, to allow all abilities access as well as assisting day to day transfer of heavy equipment between levels. Some preliminary investigations for a lift location have been investigated and this project has commenced. The Advisory Board has confirmed a preferred location for the lift and this is identified on the plan adjacent.

SUMMARY OF KEY FINDINGS

3 - REVIEW OF SCHOOL ENTRY / WAYFINDING

The consultation highlighted a number of wayfinding issues with the current school design. This is a specialist area of consultancy and it is recommended that the school engage with a wayfinding specialist to assist with this work. The solutions could range from some very low-cost simple signage, and or painted super graphics, to some more involved design solutions.

Several respondents in the consultation have suggested that the main entry to the school is confusing. There is an old entry located off the staff carpark that requires redesign to ensure visitors do not try and access the school through this point. The main entry located between the Church and the John Ashe playground is quite recessive and hard to find. Possible options could include the investigation of new ground level paving, landscaping, and signage.

There is also a pedestrian gate on Wallen Street that is used for access before and after school that some visitors try and use during school hours. New signage would assist with clarifying its hours of operation and guidance to the main school entrance.

The John Ashe playground is quite difficult for the younger students to find due to its location and non-direct access. Some simple fun graphical signage could improve this issue.

4 - UNDERCOVER ACCESS TO ALL AREAS OF THE SCHOOL

The Multi-Purpose Hall is currently located to the east of the main school building and is physically disconnected. During inclement weather, access to the hall is challenging. The Hall is separated by the Mary Clare playground and two asphalted basketball courts. This asphalted area also provides a drive through drop off zone before and after school. There is potential to redesign the bathrooms at the eastern end of the junior school classrooms and introduce an exit point at the end of this building. A narrow undercover structure could be constructed along the north end of the basketball courts, providing covered access between the two buildings, except for a small section to the south of the drive through gate. This would be a relatively low cost and low impact solution, however, does raise some safety issues relating to the door opening into the drive through area. This risk could be managed by only providing access when the drive through gate is locked.

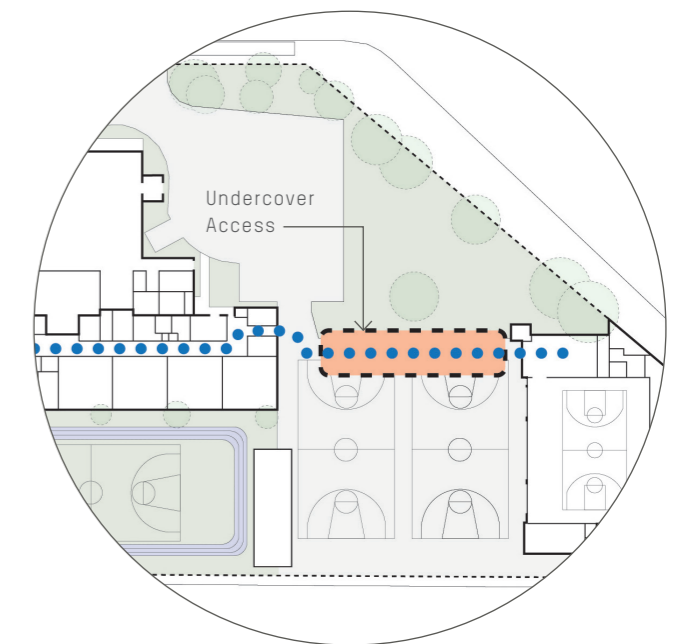

Ground Floor Plan

NEXT STEPS

The school has already undertaken, and is currently planning for a number of the identified upgrades. This document will assist with decision making on these into the future. It is envisaged that the facilities masterplan can continually be updated and amended to reflect the ongoing development of the school.

This report does not provide guidance regarding specific costings of these future works. The more significant building projects will require detailed feasibility studies to provide the School Leadership with information to make decisions about future development.



APPENDIX 1 - MASTERPLAN SURVEY & WORKSHOP SUMMARY

—

	Board Feedback - Consultation Mtg 23rd March 2021	Staff Feedback - Survey February 2021	Parent Feedback - Survey February 2021
1 – Inside Spaces / Classrooms and General Facilities			
Do the current classrooms provide good learning spaces – specialist areas and grade classrooms? Could any improvements be made? Are they in need of repair?	Some general painting and carpet tile replacement in stairs were mentioned as items for repair but this is scheduled as part of ongoing maintenance programs	Happy with indoor spaces	I would suggest that air conditioning in the main hall would make it more practical, usable and liked by students. My view is that comfort levels relate to education outcomes and focus, including for sporting activities
	Separation of current Library and Performing Arts would be good	Lift to second floor. Ability to lock door from the inside.	Yes good learning spaces
	Current class rooms are excellent - good size	Access to upstairs: with students that have broken limbs, students with 'growing' complexities, I feel the school and keeping it accessible for all, would benefit from having a lift put in. Also makes it easier to transport furniture that is bulky instead of up and down stair cases.	Air-conditioning in the hall
	Current Art room would benefit with a better connection to outside (John Ashe Playground)	I like the variety of the tables and chairs in the Year 5 classrooms, as do the students. However, those provided are adequate for up to approx. 24 students, but I find it difficult to squeeze in my 27. They are quite squashed, so find it difficult to organise their working space.	Elevator required
	Dedicated library with flexible spaces (ACU library)	A separate storage facility for out of school basketball and netball club equipment, possibly near the water tanks or the back of the healthy hut so that it is accessible through the side door of the hall. This would free up some internal hall storage space and allow for better storage of school PE and PMP equipment.	I feel the classrooms meet these areas, however not sure if it's possible to improve on this.
	Location of first aid room is great	Installing a lift to enable easier access upstairs, to cater for any students with a temporary or permanent physical disability. Also if furniture, books, office equipment etc has to be moved between floors.	
Are there any spaces for specific types of teaching that are not provided?	Would be good to have specialist Performing Arts, Italian and possible a dedicated science room with connection to outside (sustainability)		I feel you need a performance arts room instead of being located in the library. There is enough space for music and drama experiences
	Well being room could be good		
	Medium sized meeting space (for example for faith night) that is size of library but smaller than hall - Hall is soul less		
Would new flexible spaces for multiple uses/learning be desired or is it better to have dedicated spaces?	Dedicated spaces for the above would be best - current library and PA space don't work that well.		
Are any specific opportunities for repurposing existing buildings/areas? Are there any spaces that are over or underutilized?	Archive room seems large and possibly unnecessary with future on line archive - also not great up stairs? Could be better used as a breakout/meeting room		
How would you describe the current use of the library space?	Not great sharing library with performing arts		

	Board Feedback - Consultation Mtg 23rd March 2021	Staff Feedback - Survey February 2021	Parent Feedback - Survey February 2021
The current upper level classrooms provide a central shared room (pod) between each grades two classes which originally was designed as an IT/computer room. With changes in technology this use is redundant – do you see this space as necessary? Do you have any ideas for potential new use of this space? Would it be better if classrooms were larger or is this connection between the two classes a positive thing?	Time out space with visual connection is great - visual connection could be better to the 'pods'	The pods are now great for small group work, for testing students if they've missed something the day prior, LSO's to have a quieter space for some students to work with.	I am a fan of keeping classes separate - kids lives are busy and noisy enough. But I do like the pod connections in the older kids classes. The pods are a bit of an odd fit out. Is there a chance to make them more fit for purpose?
	Great additional space for learning - wish all classrooms had this Kids request to use this space if having difficulties	I personally think the shared space between the two classes is useful if support person is supporting a student/s with reading, maths or literacy task. It is also in line-sight of the classroom teacher.	
	Could possibly be better design - better fit out/ furniture		
	Leave as they are - invaluable		
Some of the other classes are separated/connected by a door between classrooms – is this adequate? Would classrooms benefit from being more/less connected to each other?	Current Art room divider works well to separate space.		
	Connection between rooms is good - door essential but could be larger - maybe large slider? Sound proofing is required		
	Access great for team teaching		
Are the toilet facilities adequate student and staff? (Gender and accessibility) Is location and number suitable?	Upstairs toilets would be good for students and staff - better proximity to classrooms	I feel the toilets are adequate, however need regular ' upkeep' to keep them fresh & smelling clean & germ free.	
	If new toilets were to be installed upstairs also consider all gender toilet? - perhaps could double with an accessible toilet as the school currently does not cater for this.	Ladies toilets - more toilets for staff.	
	Current upstairs staff toilet only has one door which isn't great for privacy		
2 – Outside Spaces			
Are current outdoor spaces adequate? Playgrounds/ Sports/Public spaces. Could any improvements be made? Are they in need of repair? Any safety concerns?	Spaces good - visibility the key for staff		
	Upgrade to Thomas Sherry playground equipment currently underway		
Any ideas for new types of spaces?			

	Board Feedback - Consultation Mtg 23rd March 2021	Staff Feedback - Survey February 2021	Parent Feedback - Survey February 2021
3 - General School Facilities Organization – Layout & Planning			
Are there any major layout organizational issues for the school? Does the current zoning of the class grades work well – junior/middle/senior?	Works well with class zoning	Yes Zoning works well	If you wanted to you could build more room above the prep and grade 1 class to look in line with the middle and senior parts of the school.
	Seniors upstairs good - breakout space good but could be improved	Layout works well, could benefit from the inclusion of a lift.	Yes - for classrooms - but not for playgrounds
	Lift access would be good	I feel the Senior classes need more space (move back to the current Yr. 2/3 area)	Seems ok.
	Upstairs rooms could be bigger but breakout space is highly valuable	The Senior (5/6) area is perfect and is effective at fostering a 'team' feel.	Zoning of class grades is good.
	Beanbags are too big		I think staff are best placed to comment on this.
	Breakout space should be redesigned after finalisation of lift location		I believe they work well.
	Visibility key - must be able to see kids if want to send them out to breakout spaces		
	Perhaps a dedicated space for Grade 5 and 6 students		
4 – Staff Facilities			
Are current facilities for staff adequate? Could any improvements be made?	Reception works well	Very adequate	I would defer to feedback from staff on their spaces, but I would rate it critical to ensuring they enjoy their spaces considering how much time they spend in the environment. I would envisage separate spaces work for some sort of 'downtime'
	Staff facilities amazing	Adequate	Yes, as the teachers require space to concentrate on work and time out from the students.
		Yes	Very Noisy for office staff - with the double doors that slam with the wind all day. The noise and people walking past must be very distracting for office staff.
		A shared office facility for specialist staff would be handy.	The staff car park is very tight for the morning drop off and afternoon pick up. Not much space but I do not have a solution.
Do staff need all the current spatial allocation – i.e. is it too generous?		The space for staff to eat and work in is a big + for this school. To be able to hold meetings in our 'Work room' with all staff, have quick access to the staffroom, office area, photocopier, is fantastic, very user-friendly.	
Connections between staff areas and student area – currently quite separate – is this suitable?	Disconnection from students is good - some confidential information in staff work room	It is a very good use of space with having a separate staff room and workroom areas for staff. I think it is good for staff to have separate area from students. It gives them an area to have a break away from the children. Also in the current pandemic situation it is good that the staff room allows for spaced out sitting when required.	

	Board Feedback - Consultation Mtg 23rd March 2021	Staff Feedback - Survey February 2021	Parent Feedback - Survey February 2021
	Good to have a break from students	Yes - very adequate. The separate work room and staff rooms ensure teachers can 'switch off' during break times.	
5 - Access / Way Finding			
Is it easy for students to find their way around the school?	John Ashe Playground a little hard to find for students - perhaps some signage could help - fun signage for younger students?	Very easy to find their way around the school	All fine to me
	When students move upstairs they feel a little lost	Easy for children to find.	Yes
			Yes
			I feel the layout and path finding is clear.
Is their adequate access to all spaces – stairs / lifts / ramps?	Need lift	We need a lift to move some students/parents to upper levels.	I am of the strong opinion that there should be a lift that makes accessibility between ground floor and upstairs more in line with modern day expectations. Whether it is for injury, those with special needs, or grandparents to be able to access the upper floor without navigating the stairs.
	Front ramp access good	Currently there is no lift to upstairs area. A lift will allow access for parents, grandparents or students who would not otherwise be able to climb stairs to access classrooms. Also a lift will allow heavy boxes to be moved upstairs to archive room etc.	Elevator up to the upstairs classrooms is on the radar and an important improvement.
		A lift for upstairs access is necessary, in case students have an injury and so we are an inclusive school for new enrolments. The school needs to be accessible and welcoming for all.	
		In terms of access to the second level - a lift would be beneficial. Currently, heavy items of furniture, boxes, equipment have to be carried up and down the stairs. This could be a hazard for staff / students carrying heavy items up / down the stairs. In the event that a student has an injury due to an accident or injury and they need to use crutches - the stairs are a hazard. A lift would be more convenient and a much safer option. Staff would be able to use trolleys to move furniture / archive boxes in a much safer manner around the school. By installing a lift, staff will also be able to use trolley bags if they prefer to use this option. The school is currently not fit for catering for disabled students who need to use wheelchairs, should there be a need.	
Is undercover access to all areas of the school necessary?	Would be good to have undercover access to hall but difficult as path crosses drive through?		
	Better undercover areas for students to stand while waiting for parents - drive through and Wallen St		

	Board Feedback - Consultation Mtg 23rd March 2021	Staff Feedback - Survey February 2021	Parent Feedback - Survey February 2021
	Possible better all weather access to hall from junior school corridor if single toilet was removed? - although clashes with drive through but could be managed with lock and gates?		
Is it easy/clear for parents to find their way around school?	Entry confusing		All fine to me
			Yes
			Yes
Is the front reception/entry to the school adequate? Is this easy to find?	Old entry to school off staff car park confusing	Front reception easy to find and accessible	St Finbars is a confusing campus. There is poor signage and it is hard to know what entrance is what at the school. It's a pickle. The site is limiting though, with the Hwy.
	Entry to school quite confusing with two street addresses. Definitely needs some consideration and wayfinding strategies - better signage etc.		For someone who may never have been to the school before I believe it would be difficult to find your way around as there is lack of signage.
	Lots of visitors and parents (deliveries) find entry confusing - especially first time new parents - not great introduction to school		
	Electric sliding doors would be good - safer than current heavy doors swinging around small children etc		
	Airlock good		
Is the connection and separation between school and church adequate?	Good level of separation - wouldn't want any more connection with church		
6 – Safety and Security			
Does the current school feel safe?	Yes very safe	My only concern would be the office staff. If anyone were to come in who wanted to cause harm, they are very easy to gain access to.	Yes very.
		Feels safe and secure	Yes, I feel it is safe or I would not bring my children to the school
		Yes	The stairs are too steep coming down from the classrooms upstairs
		Yes, extremely adequate safety measures already in place.	Yes the school feels very safe.
		The foyer is secure and all teachers carry a key - this adds to a feeling of safety. The students are happy and safe. All new teachers are across the playground policies.	Yes. Very.
		A second phone closer to the sliding orange doors would make this form of communication a lot quicker to use.	With the closing and opening of Wallen St gates and front office doors closed in school times, I do feel the school is safe.
		Yes, since the cameras have been installed.	

	Board Feedback - Consultation Mtg 23rd March 2021	Staff Feedback - Survey February 2021	Parent Feedback - Survey February 2021
Could any improvements be made?		Smoke detectors in the hall.	
7 - Sustainability			
Is there an understanding of sustainability within the school community? Could key sustainability elements around the school such as water storage/ solar panels / recycling be better incorporated into daily use? Is this done – could it be done better?	Responses to the survey from parents seems to indicate some of the sustainability initiatives are not clear despite communicating this to community?	I think the school is very good with its sustainability responsibilities.	Solar panels could be valuable if the assessment on ROI suggests it.
	Could be better outside bins for compost/recycling/ rubbish	Good understanding of sustainability across community and staff.	To be honest I don't know If the school has solar panels.
	Need to get cleaners on board with this for it to be successful	more sustainable education	Yes -to recycling of water for plants/gardens - toilets , and explained to children.
		Lisa Poulter is working really hard to implement sustainable practise at the school. Her first objective is to audit the way we use bins at the school, as this requires improvement. This area will see great progress this year, with Lisa's expertise!	Solar panels are worth exploring for an ROI.
		Sustainability leaders could also work to increase awareness of power usage in general (i.e. leaving lights and TVs on when teachers / students have left the classroom)	More plants, natural materials and nature.
		The recycling of plastics on our special lunch order days would be wonderful.	I'm still reminding my children about recycling at home, not sure if this is emphasised, it could continue throughout the higher year levels. I'm sure water storage and power saving methods could be an ongoing item for the school to review.
Do classrooms function well in terms of too hot too cold – adequate shading etc? Does school heating and cooling systems work well? Are they efficient/adequate – running costs etc?	Corridors too cold (hard to fix)	Building is well temperature controlled. Some upstairs classroom can be hot in summer.	
	Year 4 ground level west classrooms are cold	I feel a few air conditioners need replacing or fixing. 6K - system does not work well.	
	4 No upper level north and west classrooms (year 5 and 6) are too hot require year round A/C	Some type of cooling in the hall would allow for this facility to be far more comfortable for use on hot days and evenings.	
	Hall was too hot but recently had A/C installed	Tinting - upstairs classrooms (Centre Rd - facing), these classrooms get very hot in summer. If the windows are tinted, together with the blinds they can help to blockout some of the hot UV rays during summer. These two classrooms in particular get very hot and uncomfortable during the summer months.	

	Board Feedback - Consultation Mtg 23rd March 2021	Staff Feedback - Survey February 2021	Parent Feedback - Survey February 2021
Is there enough access to sun/daylight and control of this during seasonal variations? Is artificial lighting adequate – is it environmentally friendly? (could also improve running costs \$)	Upstairs classrooms good with only natural lighting	Lighting replaced recently, adequate	
	Whole school recently changed over all light fittings to LED		
8 - School Technology			
Does school have adequate technology facilities?	Upgrade interactive whiteboards - scheduled for 2021	PE program: we would love a set of Ipads and tripod stands so we can incorporate ' user-friendly' , easy-to-access IT into our program (peer-assessment, feedback, etc). A more portable speaker system would also be useful in the hall to enhance our program.	
		Specialist classes would benefit from up to date i Pads	
		Google casting can be a little unreliable at times, but good for teachers to be able to take laptops away and other use their own.	
		Year 5 rooms need another IWB control please.	
		One-to-one Chromebooks for students and the TV with Chromecast is more than adequate.	
Are classrooms setup correctly for current technology use – charging etc?	Yes charging trolleys are good	The setting up of the chrome book chargers can be time consuming and tricky to feed through charger leads.	
Is current internet connection supply adequate?	Yes but better Wi-Fi coverage would be good with better location of spreaders		
Location of server room and IT – any improvements needed?	Works well - has dedicated temp control through wall mounted split system which runs 24hrs		